

# Submittal Data Sheet Booklet

## Circulating Pumps

Product Review



### Wilo-TOP-S range

### Duty chart

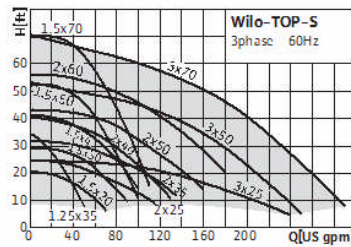
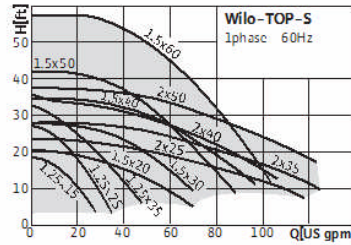

#### > Single-head pumps:

- Circulating pumps with flanged connection

#### > Applications:

- Pumps with cast iron body for all hot-water heating systems of all kinds, air-conditioning systems and closed cooling circuits.
- Pumps with bronze body for all warm and hot water, heating applications in open circulating systems.

#### > Special features:

- Cathaphoresis coating for preventing corrosion in the event of condensation.
- Maintenance free single-head circulator.
- 2 speed motor
- Aluminium terminal box



# WILO TOP S Submittal

Top S 1.25 x 15 Single Phase Series



Pumpen Intelligenz.

|               |       |
|---------------|-------|
| Project:      |       |
| Engineer:     |       |
| Contractor:   |       |
| Submitted By: | Date: |
| Approved By:  | Date: |

| Tag # | Model #         | Flow | Head | Volt | Phase | Comments |
|-------|-----------------|------|------|------|-------|----------|
|       | TOP S 1.25 X 15 |      |      |      | 1     |          |
|       | TOP S 1.25 X 15 |      |      |      | 1     |          |

| Details  | Max Hp  | Pipe Size | l <sub>0</sub> | l <sub>1</sub> | l <sub>2</sub> | a <sub>1</sub> | a <sub>2</sub> | b <sub>1</sub> | b <sub>2</sub> | b <sub>4</sub> | b <sub>6</sub> | Weight   |
|----------|---------|-----------|----------------|----------------|----------------|----------------|----------------|----------------|----------------|----------------|----------------|----------|
| Imperial | 1/8 Hp  | 1 1/4"    | 6 1/2          | 3 1/4          | 4 3/16         | 7 11/16        | 1 1/4          | 2 9/16         | 2 3/16         | 2 3/4          | 3 5/16         | 13.7 lbs |
| Metric   | 80 Watt | 32 mm     | 165            | 82.5           | 106            | 195            | 32             | 65.5           | 56             | 70             | 83.5           | 6.2 kg   |

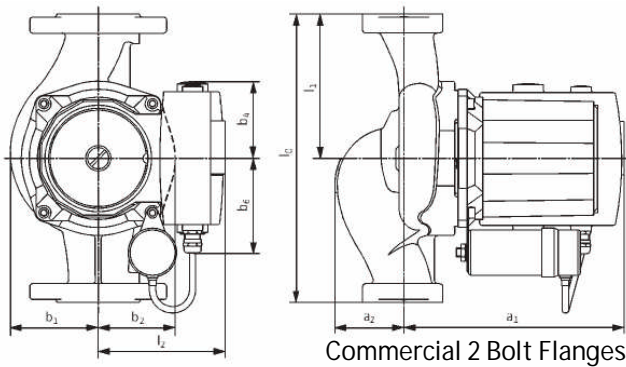

| Speed | RPM  | Max Watts | Amps<br>115 V | Amps<br>230 V |
|-------|------|-----------|---------------|---------------|
| Max   | 3200 | 145       | 1.40          | 0.70          |
| Min   | 2950 | 140       | 1.30          | 0.60          |

|                   |                  |                       |
|-------------------|------------------|-----------------------|
| 140 deg F (60 C)  | 194 deg F (90 C) | Min Inlet<br>Pressure |
| 1.8 PSI ( 12 kpa) | 7.3 PSI (50 kpa) |                       |

#### Operating Limits

Max Temp 14 to 248 Deg F (- 10 to 120 Deg C)  
 Max Ambient Temp 104 Deg F (40 Deg C)  
 Max Working Pressure 145 PSI (10 Bar)

#### Materials of Construction

Impeller Polypropylene (50% Glass Filled)  
 Shaft Stainless Steel (X40 Cr13)  
 Bearing Metal Impregnated Carbon  
 Volute Cast Iron (Closed Systems)  
 Cataphoresis Coated

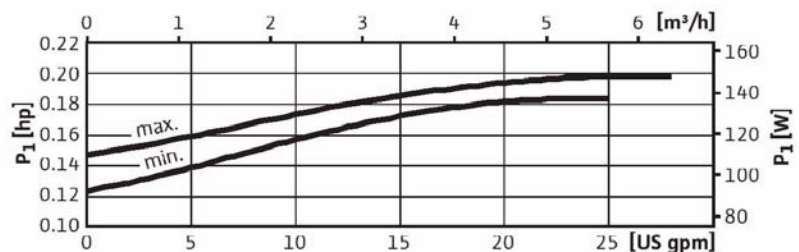
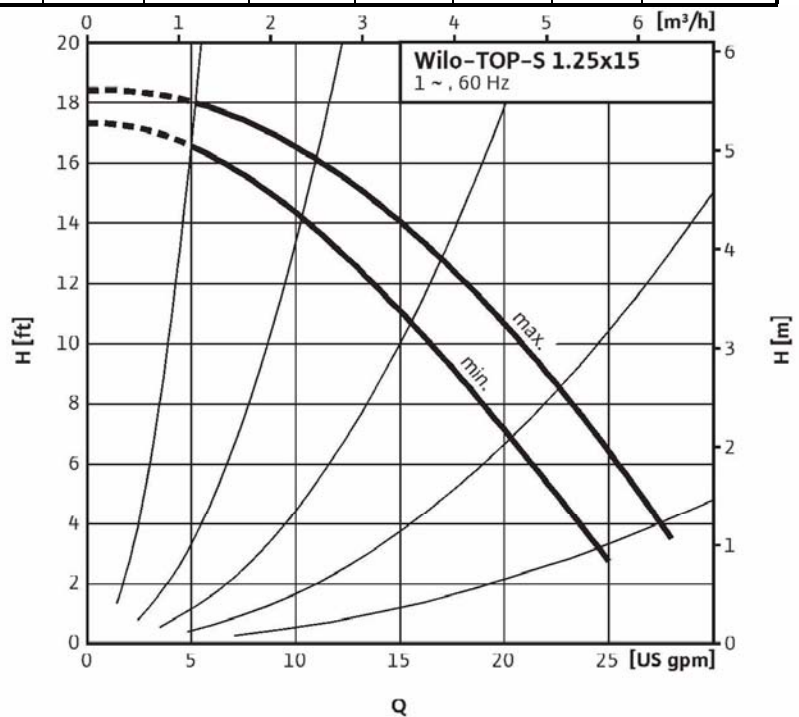

Wilo USA LLC  
 1290 North 25th Avenue  
 Melrose Park, Illinois 60160  
 Phone: 866 945 6872 Fax: 708 338 9455  
 www.wilo-na.com

Wilo Canada Inc  
 Bay 7 - 2915 - 10th Ave N. E.  
 Calgary, Alberta, T2A 5L4  
 Phone: 866 945 6236 Fax: 403 277 9456  
 www.wilo-na.com



# WILO TOP S Submittal

Top S 1.25 x 25 Single Phase Series



Pumpen Intelligenz.

|               |       |
|---------------|-------|
| Project:      |       |
| Engineer:     |       |
| Contractor:   |       |
| Submitted By: | Date: |
| Approved By:  | Date: |

| Tag # | Model #         | Flow | Head | Volt | Phase | Comments |
|-------|-----------------|------|------|------|-------|----------|
|       | TOP S 1.25 X 25 |      |      |      | 1     |          |
|       | TOP S 1.25 X 25 |      |      |      | 1     |          |

| Details  | Max Hp  | Pipe Size | l0    | l1    | l2     | a1      | a2    | b1     | b2     | b4    | b6     | Weight   |
|----------|---------|-----------|-------|-------|--------|---------|-------|--------|--------|-------|--------|----------|
| Imperial | 1/8 Hp  | 1 1/4"    | 6 1/2 | 3 1/4 | 4 3/16 | 7 11/16 | 1 1/4 | 2 9/16 | 2 3/16 | 2 3/4 | 3 5/16 | 14.1 lbs |
| Metric   | 90 Watt | 32 mm     | 165   | 82.5  | 106    | 195     | 32    | 65.5   | 56     | 70    | 83.5   | 6.2 kg   |

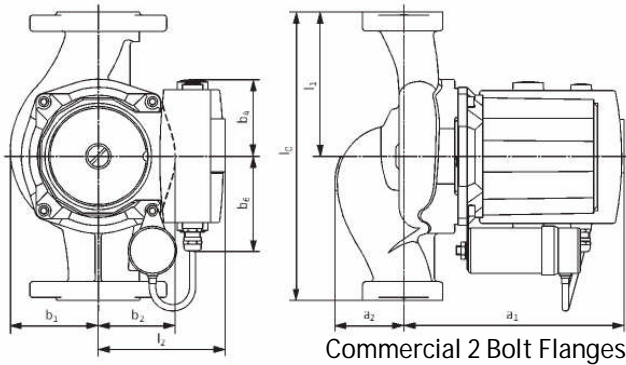

| Speed | RPM  | Max Watts | Amps<br>115 V | Amps<br>230 V |
|-------|------|-----------|---------------|---------------|
| Max   | 3100 | 215       | 2.0           | 1.0           |
| Min   | 2750 | 195       | 1.9           | 0.9           |

|                   |                  |                    |
|-------------------|------------------|--------------------|
| 140 deg F (60 C)  | 194 deg F (90 C) | Min Inlet Pressure |
| 1.8 PSI ( 12 kpa) | 7.3 PSI (50 kpa) |                    |

**Operating Limits**

Max Temp 14 to 248 Deg F (- 10 to 120 Deg C)  
 Max Ambient Temp 104 Deg F (40 Deg C)  
 Max Working Pressure 145 PSI (10 Bar)

**Materials of Construction**

Impeller Polypropylene (50% Glass Filled)  
 Shaft Stainless Steel (X40 Cr13)  
 Bearing Metal Impregnated Carbon  
 Volute Cast Iron (Closed Systems)  
 Cataphoresis Coated

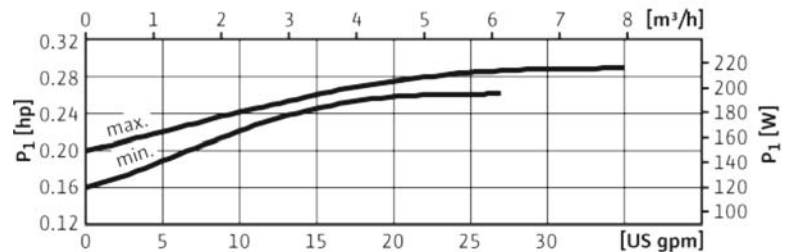
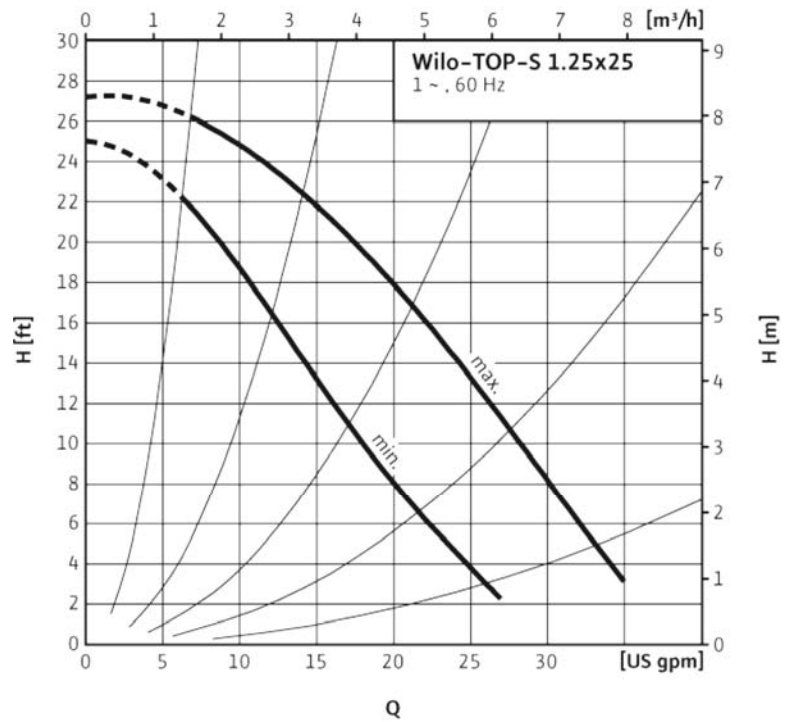

Wilco USA LLC  
 1290 North 25th Avenue  
 Melrose Park, Illinois 60160  
 Phone: 866 945 6872 Fax: 708 338 9455  
 www.wilo-na.com

Wilco Canada Inc  
 Bay 7 - 2915 - 10th Ave N. E.  
 Calgary, Alberta, T2A 5L4  
 Phone: 866 945 6236 Fax: 403 277 9456  
 www.wilo-na.com



# WILO TOP S Submittal

Top S 1.25 x 35 Single Phase Series



Pumpen Intelligenz.

|               |       |
|---------------|-------|
| Project:      |       |
| Engineer:     |       |
| Contractor:   |       |
| Submitted By: | Date: |
| Approved By:  | Date: |

| Tag # | Model #         | Flow | Head | Volt | Phase | Comments |
|-------|-----------------|------|------|------|-------|----------|
|       | TOP S 1.25 X 35 |      |      |      | 1     |          |
|       | TOP S 1.25 X 35 |      |      |      | 1     |          |

| Details  | Max Hp   | Pipe Size | l0    | l1    | l2     | a1      | a2      | b1      | b2    | b4    | b6     | Weight   |
|----------|----------|-----------|-------|-------|--------|---------|---------|---------|-------|-------|--------|----------|
| Imperial | 1/4 Hp   | 1 1/4"    | 8 1/2 | 4 1/4 | 4 7/16 | 7 11/16 | 1 11/16 | 2 11/16 | 2 3/8 | 2 3/4 | 3 5/16 | 18.5 lbs |
| Metric   | 180 Watt | 32 mm     | 216   | 108   | 113    | 195     | 42.5    | 69      | 60    | 70    | 83.5   | 8.4 kg   |

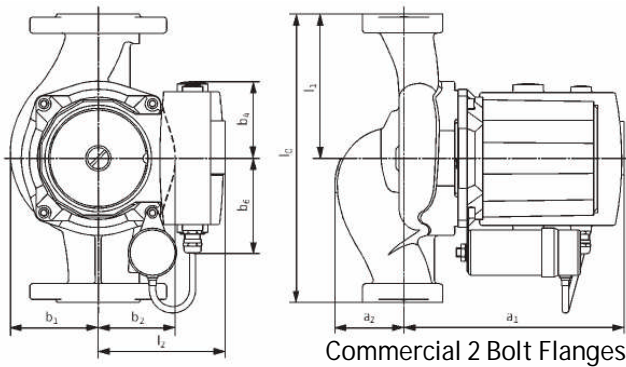

| Speed | RPM  | Max Watts | Amps<br>115 V | Amps<br>230 V |
|-------|------|-----------|---------------|---------------|
| Max   | 3250 | 315       | 3.1           | 1.6           |
| Min   | 3050 | 305       | 2.9           | 1.5           |

|                   |                  |                       |
|-------------------|------------------|-----------------------|
| 140 deg F (60 C)  | 194 deg F (90 C) | Min Inlet<br>Pressure |
| 1.8 PSI ( 12 kpa) | 7.3 PSI (50 kpa) |                       |

**Operating Limits**

Max Temp 14 to 248 Deg F (- 10 to 120 Deg C)  
 Max Ambient Temp 104 Deg F (40 Deg C)  
 Max Working Pressure 145 PSI (10 Bar)

**Materials of Construction**

Impeller Polypropylene (50% Glass Filled)  
 Shaft Stainless Steel (X40 Cr13)  
 Bearing Metal Impregnated Carbon  
 Volute Cast Iron (Closed Systems)  
 Cataphoresis Coated

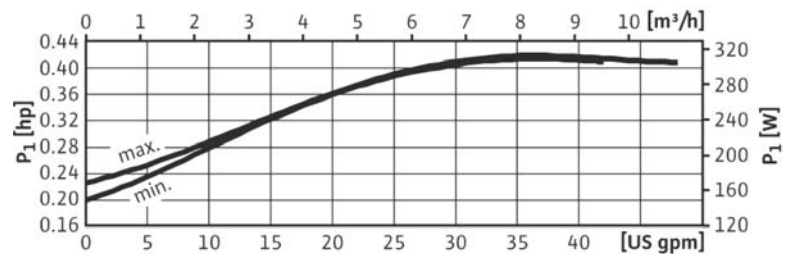
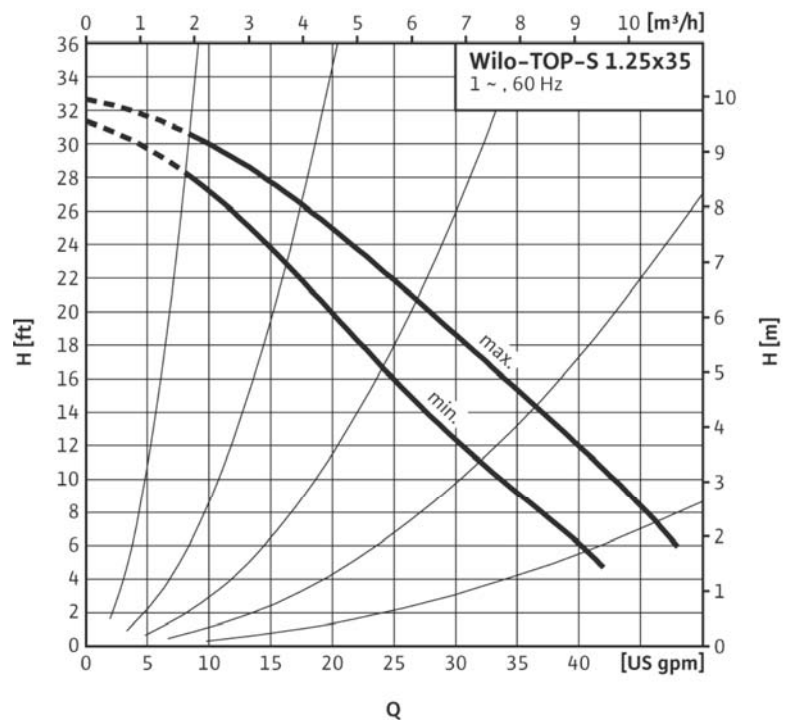

Wilo USA LLC  
 1290 North 25th Avenue  
 Melrose Park, Illinois 60160  
 Phone: 866 945 6872 Fax: 708 338 9455  
 www.wilo-na.com

Wilo Canada Inc  
 Bay 7 - 2915 - 10th Ave N. E.  
 Calgary, Alberta, T2A 5L4  
 Phone: 866 945 6236 Fax: 403 277 9456  
 www.wilo-na.com



# WILO TOP S Submittal

Top S 1.5 x 20 Single Phase Series



Pumpen Intelligenz.

|               |       |
|---------------|-------|
| Project:      |       |
| Engineer:     |       |
| Contractor:   |       |
| Submitted By: | Date: |
| Approved By:  | Date: |

| Tag # | Model #        | Flow | Head | Volt | Phase | Comments |
|-------|----------------|------|------|------|-------|----------|
|       | TOP S 1.5 X 20 |      |      |      | 1     |          |
|       | TOP S 1.5 X 20 |      |      |      | 1     |          |

| Details  | Max Hp   | Pipe Size | l0  | l1     | l2     | a1      | a2    | b1     | b2      | b4      | b6     | Weight   |
|----------|----------|-----------|-----|--------|--------|---------|-------|--------|---------|---------|--------|----------|
| Imperial | 1/4 Hp   | 1 1/2"    | 10  | 5 3/16 | 4 7/16 | 7 11/16 | 2 3/8 | 3 1/16 | 2 11/16 | 2 11/16 | 3 5/16 | 22.3 lbs |
| Metric   | 180 Watt | 40 mm     | 254 | 127    | 113    | 195     | 61    | 78     | 68      | 67.5    | 83.5   | 10.1 kg  |

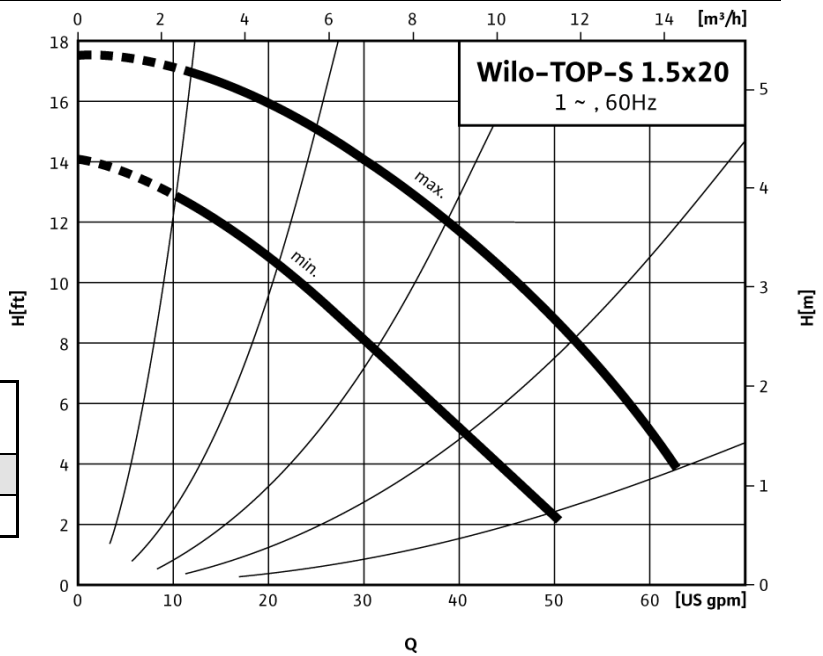
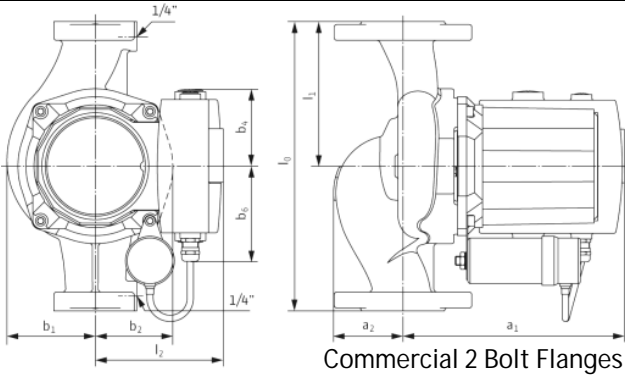

| Speed | RPM  | Max Watts | Amps 115 V | Amps 230 V |
|-------|------|-----------|------------|------------|
| Max   | 3430 | 245       | 2.30       | 1.15       |
| Min   | 3100 | 215       | 2.20       | 1.10       |

|                   |                  |                    |
|-------------------|------------------|--------------------|
| 140 deg F (60 C)  | 194 deg F (90 C) | Min Inlet Pressure |
| 1.8 PSI ( 12 kpa) | 7.3 PSI (50 kpa) |                    |

**Operating Limits**

Max Temp 14 to 248 Deg F (- 10 to 120 Deg C)  
 Max Ambient Temp 104 Deg F (40 Deg C)  
 Max Working Pressure 145 PSI (10 Bar)

**Materials of Construction**

Impeller Polypropylene (50% Glass Filled)  
 Shaft Stainless Steel (X40 Cr13)  
 Bearing Metal Impregnated Carbon  
 Volute Cast Iron (Closed Systems)  
 Cataphoresis Coated  
 Bronze Available (B Model)

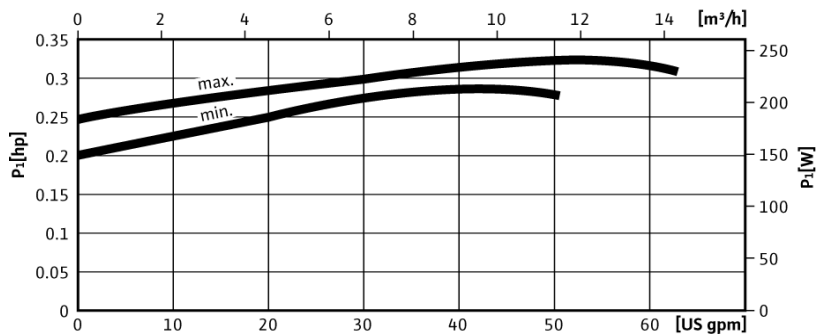

Wilo USA LLC  
 1290 North 25th Avenue  
 Melrose Park, Illinois 60160  
 Phone: 866 945 6872 Fax: 708 338 9455  
 www.wilo-na.com

Wilo Canada Inc  
 Bay 7 - 2915 - 10th Ave N. E.  
 Calgary, Alberta, T2A 5L4  
 Phone: 866 945 6236 Fax: 403 277 9456  
 www.wilo-na.com



# WILO TOP S Submittal

Top S 1.5 x 30 Single Phase Series



Pumpen Intelligenz.

|               |       |
|---------------|-------|
| Project:      |       |
| Engineer:     |       |
| Contractor:   |       |
| Submitted By: | Date: |
| Approved By:  | Date: |

| Tag # | Model #        | Flow | Head | Volt | Phase | Comments |
|-------|----------------|------|------|------|-------|----------|
|       | TOP S 1.5 X 30 |      |      |      | 1     |          |
|       | TOP S 1.5 X 30 |      |      |      | 1     |          |

| Details  | Max Hp   | Pipe Size | l0  | l1     | l2    | a1    | a2     | b1     | b2    | b4      | b6     | Weight   |
|----------|----------|-----------|-----|--------|-------|-------|--------|--------|-------|---------|--------|----------|
| Imperial | 5/8 Hp   | 1 1/2"    | 10  | 5 3/16 | 4 3/4 | 9 1/4 | 2 5/16 | 3 9/16 | 3 1/8 | 2 11/16 | 3 5/16 | 31.5 lbs |
| Metric   | 450 Watt | 40 mm     | 254 | 127    | 120   | 235   | 58     | 90     | 79    | 67.5    | 83.5   | 14.3 kg  |

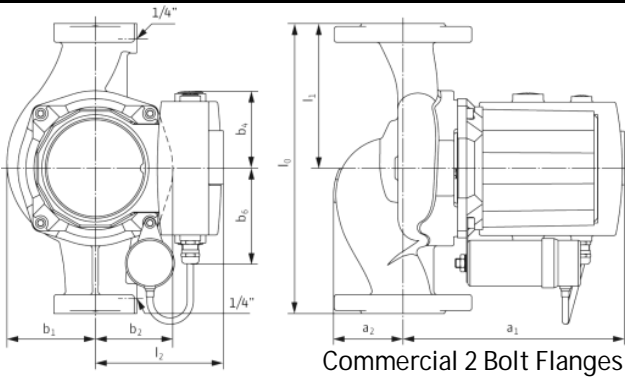

| Speed | RPM  | Max Watts | Amps 115 V | Amps 230 V |
|-------|------|-----------|------------|------------|
| Max   | 3520 | 570       | 5.25       | 2.63       |
| Min   | 3400 | 515       | 5.2        | 2.60       |

|                   |                  |                    |
|-------------------|------------------|--------------------|
| 140 deg F (60 C)  | 194 deg F (90 C) | Min Inlet Pressure |
| 1.8 PSI ( 12 kpa) | 7.3 PSI (50 kpa) |                    |

### Operating Limits

Max Temp 14 to 248 Deg F (- 10 to 120 Deg C)  
 Max Ambient Temp 104 Deg F (40 Deg C)  
 Max Working Pressure 145 PSI (10 Bar)

### Materials of Construction

Impeller Polypropylene (50% Glass Filled)  
 Shaft Stainless Steel (X40 Cr13)  
 Bearing Metal Impregnated Carbon  
 Volute Cast Iron (Closed Systems)  
 Cataphoresis Coated  
 Bronze Available (B Model)

Wilco USA LLC

1290 North 25th Avenue  
 Melrose Park, Illinois 60160

Phone: 866 945 6872 Fax: 708 338 9455

www.wilo-na.com

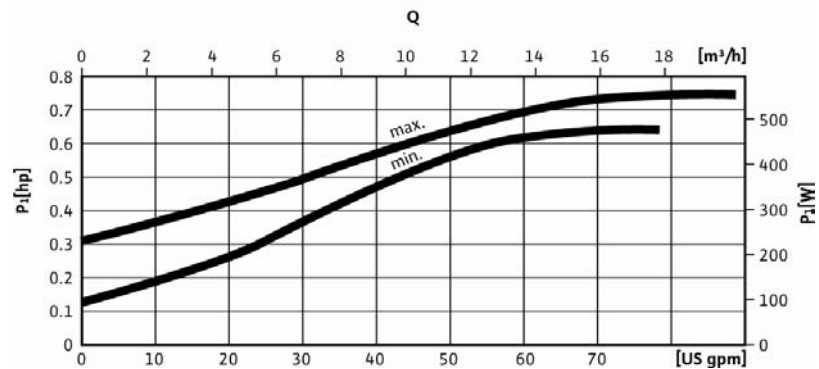
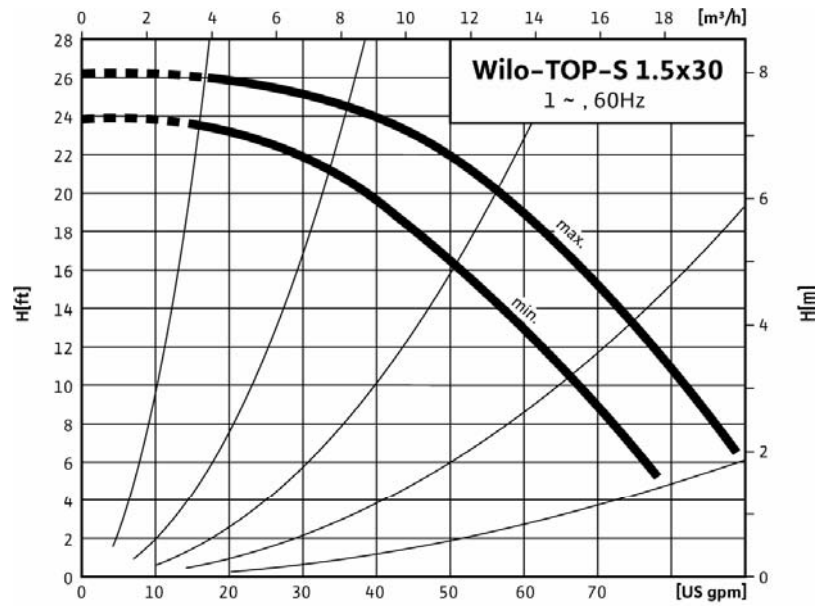

Wilco Canada Inc

Bay 7 - 2915 - 10th Ave N. E.  
 Calgary, Alberta, T2A 5L4

Phone: 866 945 6236 Fax: 403 277 9456

www.wilo-na.com



# WILO TOP S Submittal

Top S 1.5 x 40 Single Phase Series



Pumpen Intelligenz.

|               |       |
|---------------|-------|
| Project:      |       |
| Engineer:     |       |
| Contractor:   |       |
| Submitted By: | Date: |
| Approved By:  | Date: |

| Tag # | Model #        | Flow | Head | Volt | Phase | Comments |
|-------|----------------|------|------|------|-------|----------|
|       | TOP S 1.5 X 40 |      |      |      | 1     |          |
|       | TOP S 1.5 X 40 |      |      |      | 1     |          |

| Details  | Max Hp   | Pipe Size | l0  | l1  | l2    | a1    | a2     | b1     | b2    | b4    | b6     | Weight   |
|----------|----------|-----------|-----|-----|-------|-------|--------|--------|-------|-------|--------|----------|
| Imperial | 5/8 Hp   | 1 1/2"    | 10  | 5   | 4 3/4 | 9 1/4 | 2 5/16 | 3 9/16 | 3 1/8 | 2 3/4 | 3 5/16 | 31.5 lbs |
| Metric   | 450 Watt | 40 mm     | 254 | 127 | 120   | 235   | 58     | 90     | 79    | 70    | 83.5   | 14.3 kg  |

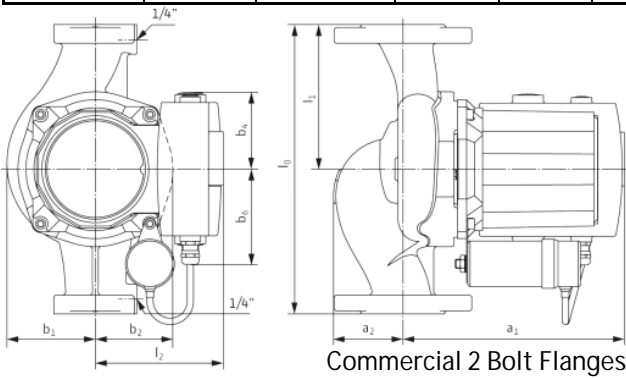

| Speed | RPM  | Max Watts | Amps 115 V | Amps 230 V |
|-------|------|-----------|------------|------------|
| Max   | 3350 | 755       | 7.5        | 3.8        |
| Min   | 3200 | 745       | 7.2        | 3.6        |

|                   |                  |                    |
|-------------------|------------------|--------------------|
| 140 deg F (60 C)  | 194 deg F (90 C) | Min Inlet Pressure |
| 1.8 PSI ( 12 kpa) | 7.3 PSI (50 kpa) |                    |

### Operating Limits

Max Temp 14 to 248 Deg F ( - 10 to 120 Deg C)  
 Max Ambient Temp 104 Deg F (40 Deg C)  
 Max Working Pressure 145 PSI (10 Bar)

### Materials of Construction

Impeller Polypropylene (50% Glass Filled)  
 Shaft Stainless Steel (X40 Cr13)  
 Bearing Metal Impregnated Carbon  
 Volute Cast Iron (Closed Systems)  
 Cataphoresis Coated  
 Bronze Available (B Model)

Wilco USA LLC

1290 North 25th Avenue

Melrose Park, Illinois 60160

Phone: 866 945 6872

Fax: 708 338 0455

www.wilo-na.com

Wilco Canada Inc

Bay 7 - 2915 - 10th Ave N. E.

Calgary, Alberta, T2A 5L4

Phone: 866 945 6236

Fax: 403 277 9456

www.wilo-na.com

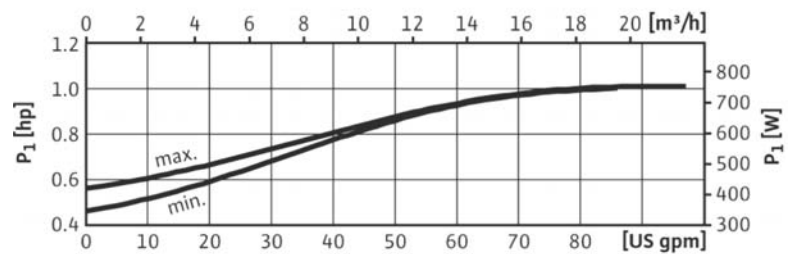
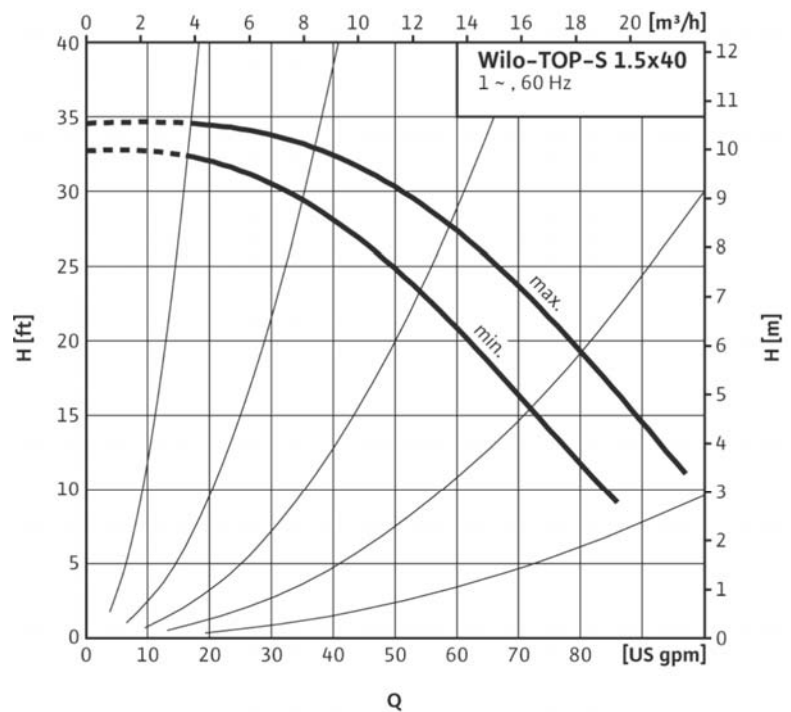



# WILO TOP S Submittal

Top S 1.5 x 50 Single Phase Series



Pumpen Intelligenz.

|               |       |
|---------------|-------|
| Project:      |       |
| Engineer:     |       |
| Contractor:   |       |
| Submitted By: | Date: |
| Approved By:  | Date: |

| Tag # | Model #        | Flow | Head | Volt | Phase | Comments |
|-------|----------------|------|------|------|-------|----------|
|       | TOP S 1.5 X 50 |      |      |      | 1     |          |
|       | TOP S 1.5 X 50 |      |      |      | 1     |          |

| Details  | Max Hp   | Pipe Size | l0  | l1  | l2    | a1     | a2    | b1    | b2    | b4    | b6     | Weight   |
|----------|----------|-----------|-----|-----|-------|--------|-------|-------|-------|-------|--------|----------|
| Imperial | 3/4 Hp   | 1 1/2"    | 10  | 5   | 5 1/8 | 10 7/8 | 2 1/8 | 3 7/8 | 3 3/8 | 2 3/4 | 3 5/16 | 44.1 lbs |
| Metric   | 570 Watt | 40 mm     | 254 | 127 | 130   | 277    | 54    | 99    | 86    | 70    | 83.5   | 20.0 kg  |

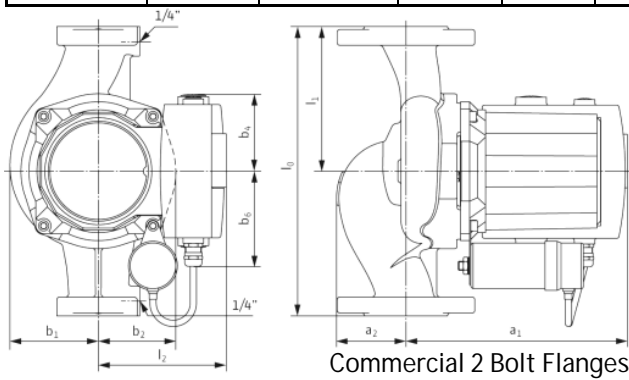

| Speed | RPM  | Max Watts | Amps 115 V | Amps 230 V |
|-------|------|-----------|------------|------------|
| Max   | 3150 | 820       | 7.8        | 3.9        |
| Min   | 2800 | 700       | 7.4        | 3.7        |

| 140 deg F (60 C)  | 194 deg F (90 C) | Min Inlet Pressure |
|-------------------|------------------|--------------------|
| 1.8 PSI ( 12 kpa) | 7.3 PSI (50 kpa) |                    |

### Operating Limits

Max Temp 14 to 248 Deg F (- 10 to 120 Deg C)  
 Max Ambient Temp 104 Deg F (40 Deg C)  
 Max Working Pressure 145 PSI (10 Bar)

### Materials of Construction

Impeller Polypropylene (50% Glass Filled)  
 Shaft Stainless Steel (X40 Cr13)  
 Bearing Metal Impregnated Carbon  
 Volute Cast Iron (Closed Systems)  
 Cataphoresis Coated

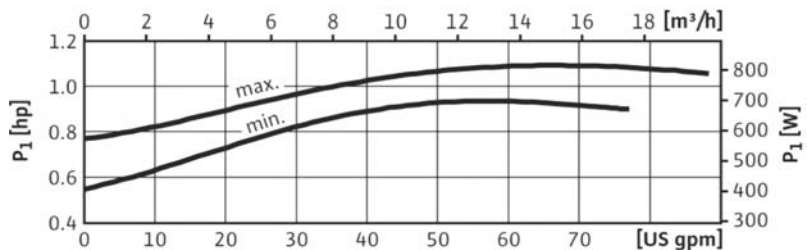
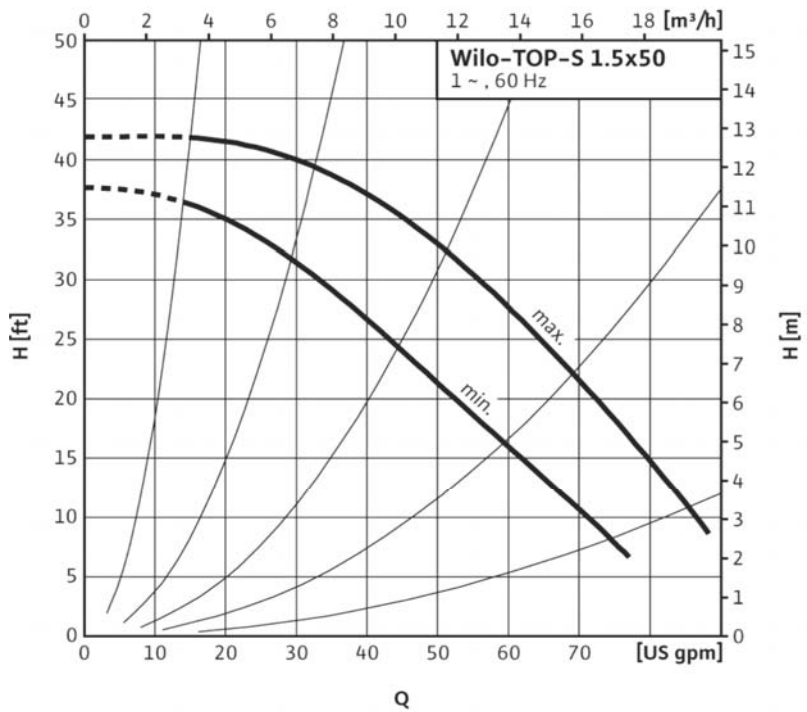

Wilo USA LLC  
 1290 North 25th Avenue  
 Melrose Park, Illinois 60160  
 Phone: 866 945 6872 Fax: 708 338 0455  
 www.wilo-na.com

Wilo Canada Inc  
 Bay 7 - 2915 - 10th Ave N. E.  
 Calgary, Alberta, T2A 5L4  
 Phone: 866 945 6236 Fax: 403 277 9456  
 www.wilo-na.com





# WILO TOP S Submittal

Top S 1.5 x 60 Single Phase Series



Pumpen Intelligenz.

|               |       |
|---------------|-------|
| Project:      |       |
| Engineer:     |       |
| Contractor:   |       |
| Submitted By: | Date: |
| Approved By:  | Date: |

| Tag # | Model #        | Flow | Head | Volt | Phase | Comments |
|-------|----------------|------|------|------|-------|----------|
|       | TOP S 1.5 X 60 |      |      |      | 1     |          |
|       | TOP S 1.5 X 60 |      |      |      | 1     |          |

| Details  | Max Hp    | Pipe Size | l0  | l1  | l2    | a1     | a2    | b1    | b2    | b4    | b6     | Weight   |
|----------|-----------|-----------|-----|-----|-------|--------|-------|-------|-------|-------|--------|----------|
| Imperial | 1 1/2 Hp  | 1 1/2"    | 10  | 5   | 5 1/8 | 10 7/8 | 2 1/8 | 3 7/8 | 3 3/8 | 2 3/4 | 3 5/16 | 48.9 lbs |
| Metric   | 1100 Watt | 40 mm     | 254 | 127 | 130   | 277    | 54    | 99    | 86    | 70    | 83.5   | 22.2 kg  |

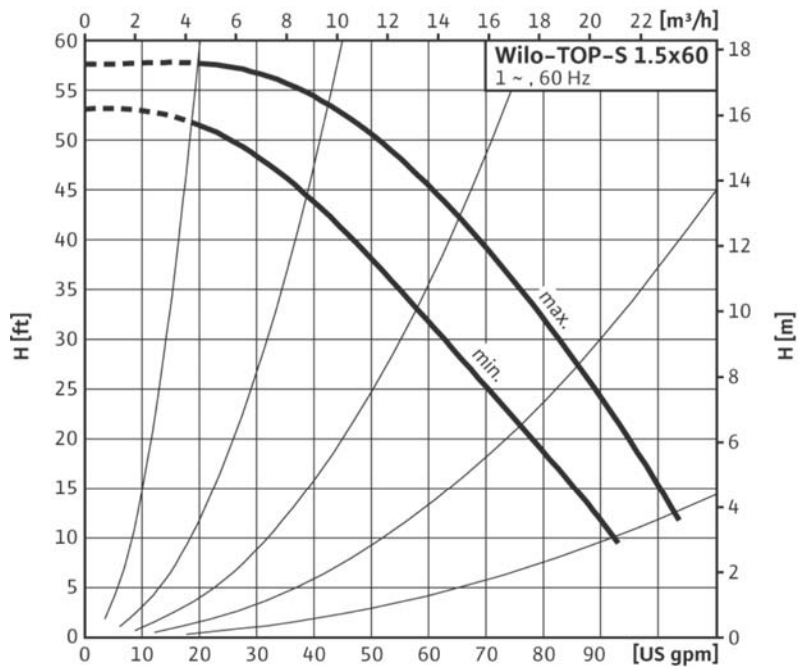
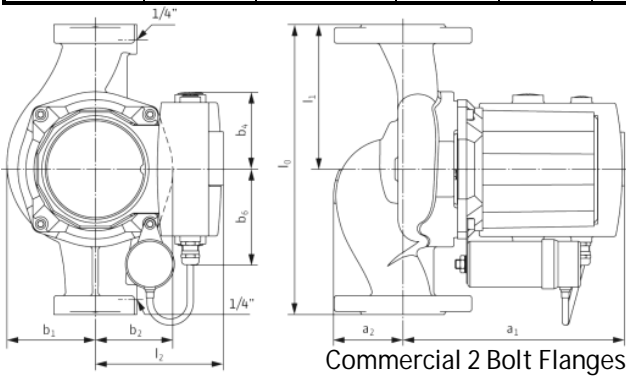

| Speed | RPM  | Max Watts | Amps 115 V | Amps 230 V |
|-------|------|-----------|------------|------------|
| Max   | 3300 | 1255      | N/A        | 6.0        |
| Min   | 2950 | 1110      | N/A        | 5.7        |

|                   |                  |                    |
|-------------------|------------------|--------------------|
| 140 deg F (60 C)  | 194 deg F (90 C) | Min Inlet Pressure |
| 1.8 PSI ( 12 kpa) | 7.3 PSI (50 kpa) |                    |

**Operating Limits**

Max Temp 14 to 248 Deg F ( - 10 to 120 Deg C)  
 Max Ambient Temp 104 Deg F (40 Deg C)  
 Max Working Pressure 145 PSI (10 Bar)

**Materials of Construction**

Impeller Polypropylene (50% Glass Filled)  
 Shaft Stainless Steel (X40 Cr13)  
 Bearing Metal Impregnated Carbon  
 Volute Cast Iron (Closed Systems)  
 Cataphoresis Coated

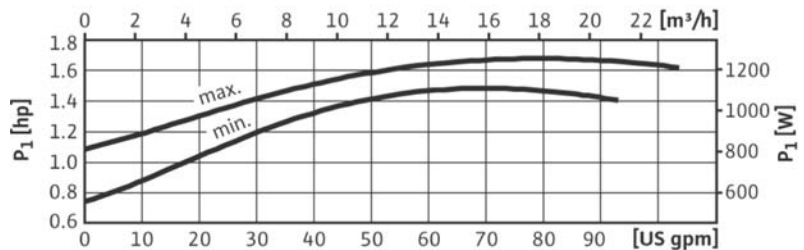

Wilo USA LLC  
 1290 North 25th Avenue  
 Melrose Park, Illinois 60160  
 Phone: 866 945 6872 Fax: 708 338 0455  
 www.wilo-na.com

Wilo Canada Inc  
 Bay 7 - 2915 - 10th Ave N. E.  
 Calgary, Alberta, T2A 5L4  
 Phone: 866 945 6236 Fax: 403 277 9456  
 www.wilo-na.com



# WILO TOP S Submittal

Top S 2.0 x 25 Single Phase Series



Pumpen Intelligenz.

|               |       |
|---------------|-------|
| Project:      |       |
| Engineer:     |       |
| Contractor:   |       |
| Submitted By: | Date: |
| Approved By:  | Date: |

| Tag # | Model #        | Flow | Head | Volt | Phase | Comments |
|-------|----------------|------|------|------|-------|----------|
|       | TOP S 2.0 X 25 |      |      |      | 1     |          |
|       | TOP S 2.0 X 25 |      |      |      | 1     |          |

| Details  | Max Hp   | Pipe Size | l0  | l1    | l2    | a1     | a2    | b1     | b2 | b4      | b6     | Weight   |
|----------|----------|-----------|-----|-------|-------|--------|-------|--------|----|---------|--------|----------|
| Imperial | 5/8 Hp   | 2"        | 11  | 5 1/2 | 4 3/4 | 9 9/16 | 2 1/2 | 3 9/16 | 3  | 2 11/16 | 3 5/16 | 36.8 lbs |
| Metric   | 450 Watt | 50 mm     | 279 | 139.5 | 120   | 243    | 64    | 91     | 76 | 67.5    | 83.5   | 16.7 kg  |

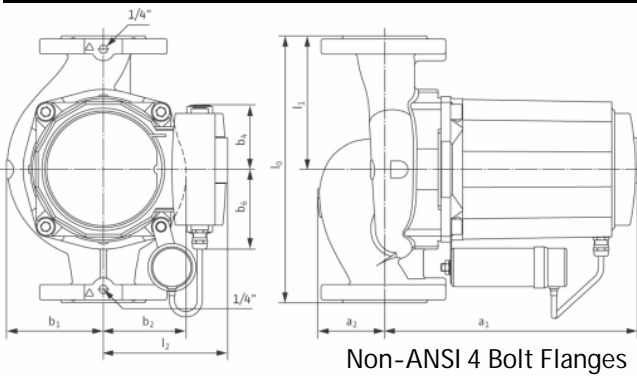

| Speed | RPM  | Max Watts | Amps 115 V | Amps 230 V |
|-------|------|-----------|------------|------------|
| Max   | 3470 | 565       | 5.20       | 2.60       |
| Min   | 3240 | 510       | 5.15       | 2.58       |

|                  |                    |                    |
|------------------|--------------------|--------------------|
| 140 deg F (60 C) | 194 deg F (90 C)   | Min Inlet Pressure |
| 6.3 PSI (43 kpa) | 15.4 PSI (105 kpa) |                    |

### Operating Limits

Max Temp 14 to 248 Deg F (- 10 to 120 Deg C)  
 Max Ambient Temp 104 Deg F (40 Deg C)  
 Max Working Pressure 145 PSI (10 Bar)

### Materials of Construction

Impeller Polypropylene (50% Glass Filled)  
 Shaft Stainless Steel (X40 Cr13)  
 Bearing Metal Impregnated Carbon  
 Volute Cast Iron (Closed Systems)  
 Cataphoresis Coated  
 Bronze Available (B Model)

Wilo USA LLC

1290 North 25th Avenue

Melrose Park, Illinois 60160

Phone: 866 945 6872

Fax: 708 338 9455

www.wilo-na.com

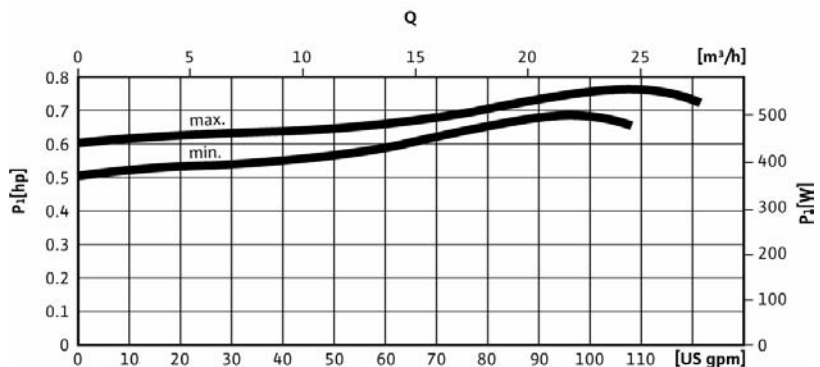
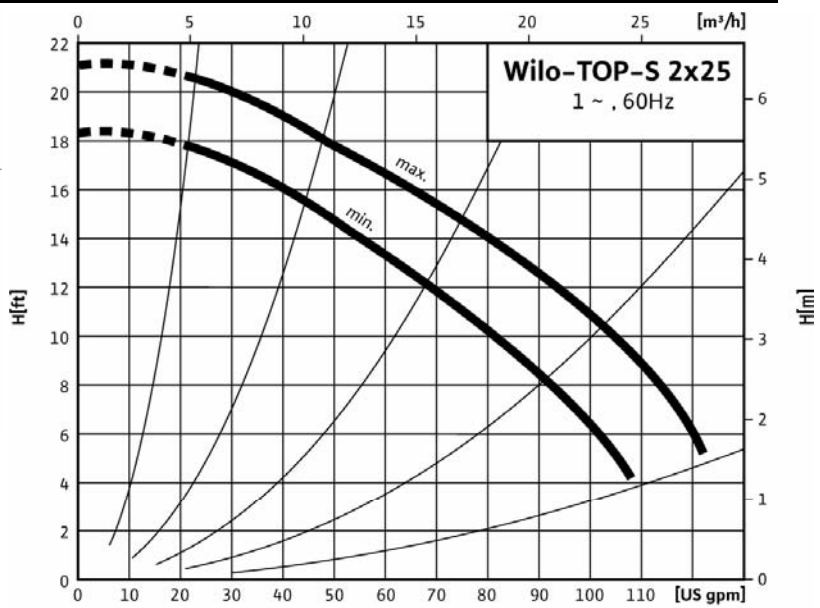

Wilo Canada Inc

Bay 7 - 2915 - 10th Ave N. E.

Calgary, Alberta, T2A 5L4

Phone: 866 945 6236

Fax: 403 277 9456

www.wilo-na.com



# WILO TOP S Submittal

Top S 2.0 x 35 Single Phase Series



Pumpen Intelligenz.

|               |       |
|---------------|-------|
| Project:      |       |
| Engineer:     |       |
| Contractor:   |       |
| Submitted By: | Date: |
| Approved By:  | Date: |

| Tag # | Model #        | Flow | Head | Volt | Phase | Comments |
|-------|----------------|------|------|------|-------|----------|
|       | TOP S 2.0 X 35 |      |      |      | 1     |          |
|       | TOP S 2.0 X 35 |      |      |      | 1     |          |

| Details  | Max Hp   | Pipe Size | l0  | l1    | l2    | a1     | a2    | b1     | b2 | b4    | b6     | Weight   |
|----------|----------|-----------|-----|-------|-------|--------|-------|--------|----|-------|--------|----------|
| Imperial | 5/8 Hp   | 2"        | 11  | 5 1/2 | 4 3/4 | 9 9/16 | 2 1/2 | 3 9/16 | 3  | 2 3/4 | 3 5/16 | 36.2 lbs |
| Metric   | 450 Watt | 50 mm     | 279 | 139.5 | 120   | 243    | 64    | 91     | 76 | 70    | 83.5   | 16.4 kg  |

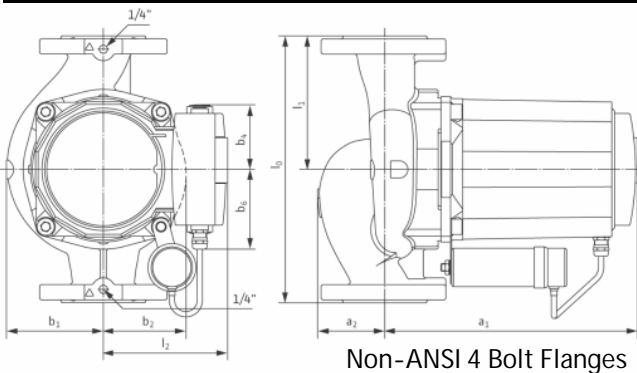

| Speed | RPM  | Max Watts | Amps 115 V | Amps 230 V |
|-------|------|-----------|------------|------------|
| Max   | 3350 | 755       | 7.5        | 3.8        |
| Min   | 3150 | 740       | 7.2        | 3.6        |

| 140 deg F (60 C) | 194 deg F (90 C)   | Min Inlet Pressure |
|------------------|--------------------|--------------------|
| 6.3 PSI (43 kpa) | 15.4 PSI (105 kpa) |                    |

### Operating Limits

Max Temp 14 to 248 Deg F (-10 to 120 Deg C)  
 Max Ambient Temp 104 Deg F (40 Deg C)  
 Max Working Pressure 145 PSI (10 Bar)

### Materials of Construction

Impeller Polypropylene (50% Glass Filled)  
 Shaft Stainless Steel (X40 Cr13)  
 Bearing Metal Impregnated Carbon  
 Volute Cast Iron (Closed Systems)  
 Cataphoresis Coated  
 Bronze Available (B Model)

Wilco USA LLC

1290 North 25th Avenue

Melrose Park, Illinois 60160

Phone: 866 945 6872

Fax: 708 338 0455

www.wilo-na.com

Wilco Canada Inc

Bay 7 - 2915 - 10th Ave N. E.

Calgary, Alberta, T2A 5L4

Phone: 866 945 6236

Fax: 403 277 9456

www.wilo-na.com

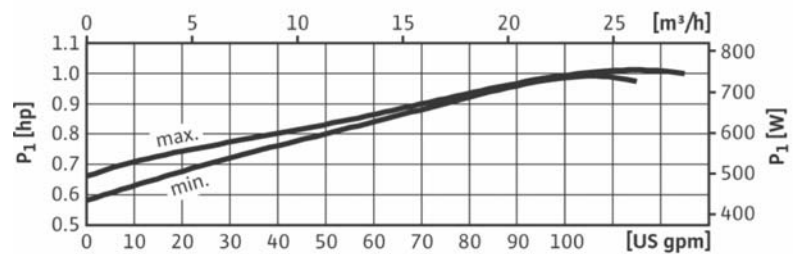
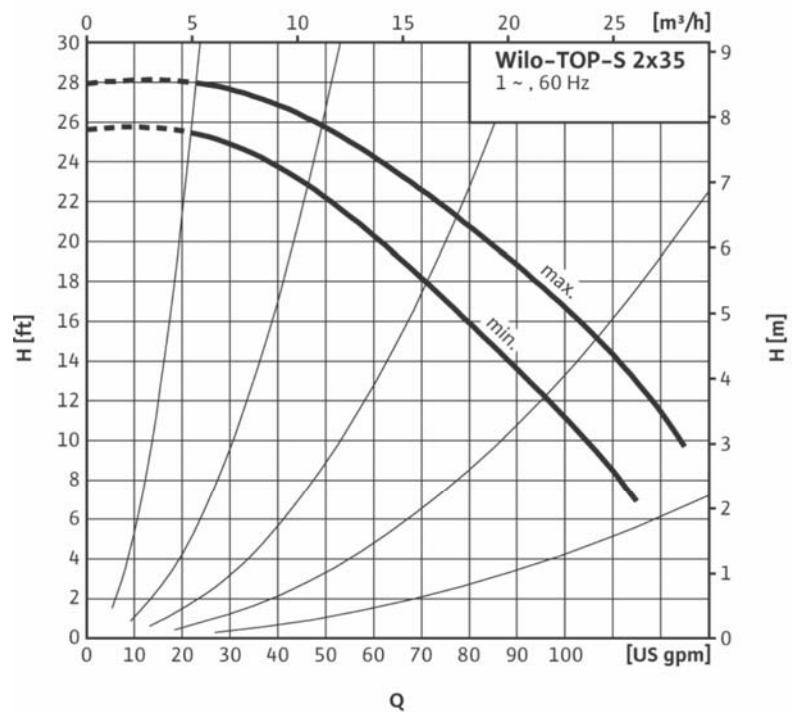



# WILO TOP S Submittal

Top S 2.0 x 40 Single Phase Series



Pumpen Intelligenz.

|               |       |
|---------------|-------|
| Project:      |       |
| Engineer:     |       |
| Contractor:   |       |
| Submitted By: | Date: |
| Approved By:  | Date: |

| Tag # | Model #        | Flow | Head | Volt | Phase | Comments |
|-------|----------------|------|------|------|-------|----------|
|       | TOP S 2.0 X 40 |      |      |      | 1     |          |
|       | TOP S 2.0 X 40 |      |      |      | 1     |          |

| Details  | Max Hp   | Pipe Size | l0  | l1    | l2    | a1     | a2    | b1  | b2    | b4    | b6     | Weight   |
|----------|----------|-----------|-----|-------|-------|--------|-------|-----|-------|-------|--------|----------|
| Imperial | 3/4 Hp   | 2"        | 11  | 5 1/2 | 5 1/8 | 10 3/8 | 2 3/4 | 4   | 3 3/8 | 2 3/4 | 3 5/16 | 46.7 lbs |
| Metric   | 570 Watt | 50 mm     | 279 | 139.5 | 130   | 263    | 70    | 101 | 86    | 70    | 83.5   | 21.2 kg  |

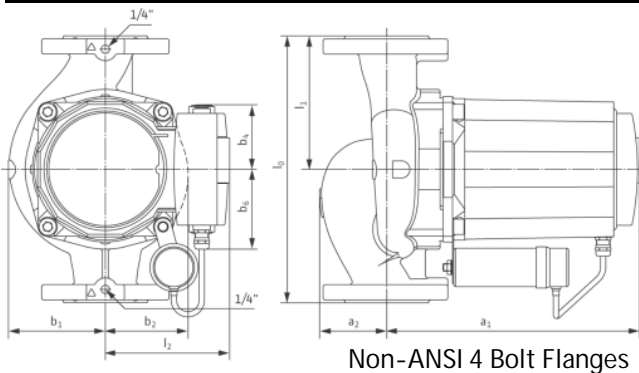

| Speed | RPM  | Max Watts | Amps 115 V | Amps 230 V |
|-------|------|-----------|------------|------------|
| Max   | 3200 | 860       | 8.0        | 4.0        |
| Min   | 2800 | 750       | 7.6        | 3.8        |

|                   |                    |                    |
|-------------------|--------------------|--------------------|
| 140 deg F (60 C)  | 194 deg F (90 C)   | Min Inlet Pressure |
| 6.3 PSI ( 43 kpa) | 15.4 PSI (105 kpa) |                    |

### Operating Limits

Max Temp 14 to 248 Deg F (- 10 to 120 Deg C)  
 Max Ambient Temp 104 Deg F (40 Deg C)  
 Max Working Pressure 145 PSI (10 Bar)

### Materials of Construction

Impeller Polypropylene (50% Glass Filled)  
 Shaft Stainless Steel (X40 Cr13)  
 Bearing Metal Impregnated Carbon  
 Volute Cast Iron (Closed Systems)  
 Cataphoresis Coated

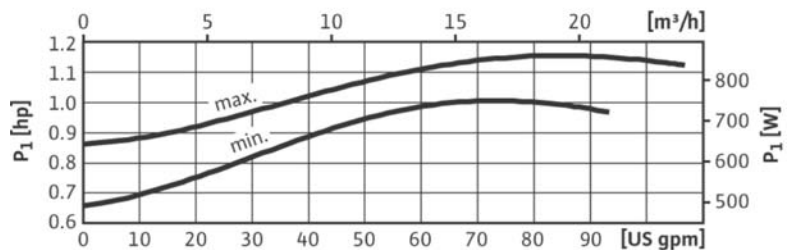
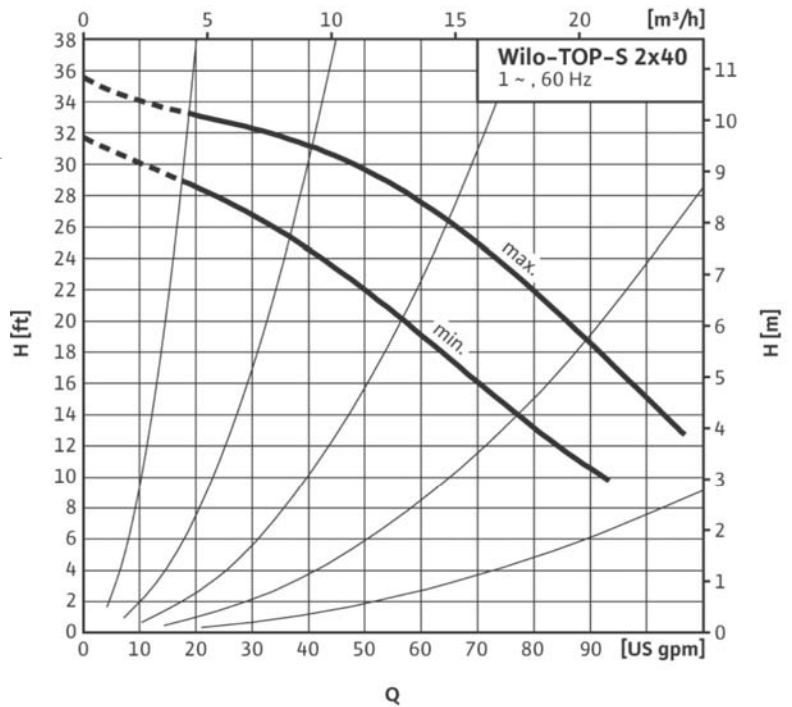

Wilo USA LLC  
 1290 North 25th Avenue  
 Melrose Park, Illinois 60160  
 Phone: 866 945 6872 Fax: 708 338 0455  
 www.wilo-na.com

Wilo Canada Inc  
 Bay 7 - 2915 - 10th Ave N. E.  
 Calgary, Alberta, T2A 5L4  
 Phone: 866 945 6236 Fax: 403 277 9456  
 www.wilo-na.com



# WILO TOP S Submittal

Top S 2.0 x 50 Single Phase Series



Pumpen Intelligenz.

|               |       |
|---------------|-------|
| Project:      |       |
| Engineer:     |       |
| Contractor:   |       |
| Submitted By: | Date: |
| Approved By:  | Date: |

| Tag # | Model #        | Flow | Head | Volt | Phase | Comments |
|-------|----------------|------|------|------|-------|----------|
|       | TOP S 2.0 X 50 |      |      |      | 1     |          |
|       | TOP S 2.0 X 50 |      |      |      | 1     |          |

| Details  | Max Hp    | Pipe Size | l0     | l1    | l2    | a1      | a2     | b1    | b2     | b4    | b6     | Weight   |
|----------|-----------|-----------|--------|-------|-------|---------|--------|-------|--------|-------|--------|----------|
| Imperial | 1 1/2 Hp  | 2"        | 13 1/2 | 6 3/4 | 5 1/8 | 11 7/16 | 3 7/16 | 4 1/8 | 3 9/16 | 2 3/4 | 3 5/16 | 55.1 lbs |
| Metric   | 1100 Watt | 50 mm     | 343    | 171.5 | 130   | 290     | 88     | 105   | 90     | 70    | 83.5   | 25.0 kg  |

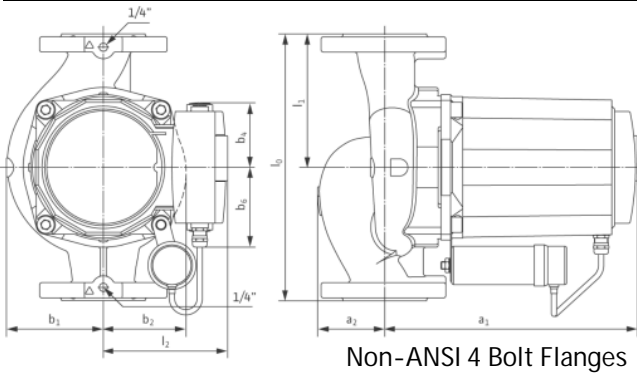

| Speed | RPM  | Max Watts | Amps 115 V | Amps 230 V |
|-------|------|-----------|------------|------------|
| Max   | 3300 | 1265      | N/A        | 6.0        |
| Min   | 2950 | 1110      | N/A        | 5.7        |

|                   |                    |                    |
|-------------------|--------------------|--------------------|
| 140 deg F (60 C)  | 194 deg F (90 C)   | Min Inlet Pressure |
| 6.3 PSI ( 43 kpa) | 15.4 PSI (105 kpa) |                    |

### Operating Limits

Max Temp 14 to 248 Deg F (- 10 to 120 Deg C)  
 Max Ambient Temp 104 Deg F (40 Deg C)  
 Max Working Pressure 145 PSI (10 Bar)

### Materials of Construction

Impeller Polypropylene (50% Glass Filled)  
 Shaft Stainless Steel (X40 Cr13)  
 Bearing Metal Impregnated Carbon  
 Volute Cast Iron (Closed Systems)  
 Cataphoresis Coated

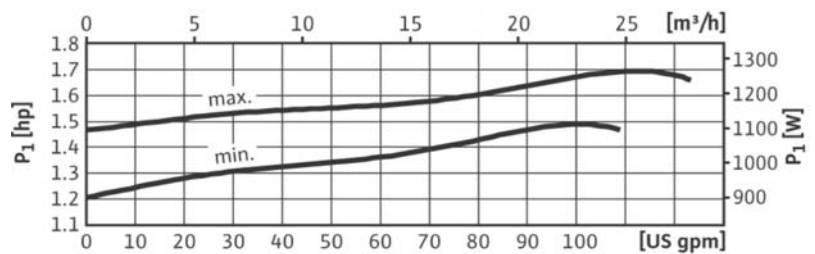
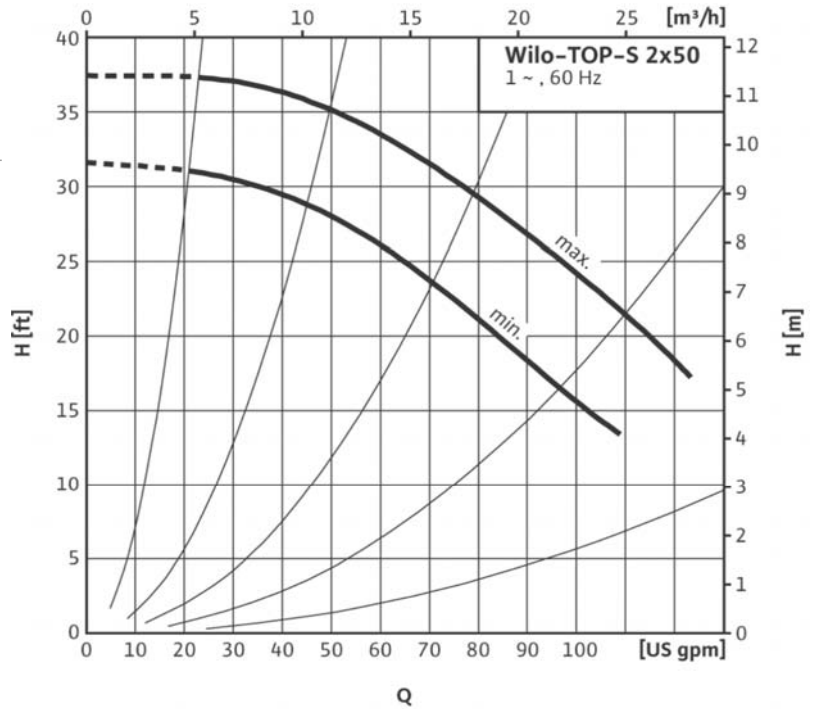

Wilo USA LLC  
 1290 North 25th Avenue  
 Melrose Park, Illinois 60160  
 Phone: 866 945 6872 Fax: 708 338 0455  
 www.wilo-na.com

Wilo Canada Inc  
 Bay 7 - 2915 - 10th Ave N. E.  
 Calgary, Alberta, T2A 5L4  
 Phone: 866 945 6236 Fax: 403 277 9456  
 www.wilo-na.com



# WILO TOP S Submittal

Top S 1.25 x 35 Three Phase Series



Pumpen Intelligenz.

|               |       |
|---------------|-------|
| Project:      |       |
| Engineer:     |       |
| Contractor:   |       |
| Submitted By: | Date: |
| Approved By:  | Date: |

| Tag # | Model #         | Flow | Head | Volt | Phase | Comments |
|-------|-----------------|------|------|------|-------|----------|
|       | TOP S 1.25 X 35 |      |      |      | 3     |          |
|       | TOP S 1.25 X 35 |      |      |      | 3     |          |

| Details  | Max Hp   | Pipe Size | l0    | l1    | l2     | a1    | a2      | b1      | b2    | b4    | b5    | Weight   |
|----------|----------|-----------|-------|-------|--------|-------|---------|---------|-------|-------|-------|----------|
| Imperial | 1/4 Hp   | 1 1/4"    | 8 1/2 | 4 1/4 | 4 7/16 | 7 5/8 | 1 11/16 | 2 11/16 | 2 3/8 | 2 3/4 | 2 3/4 | 18.5 lbs |
| Metric   | 180 Watt | 32 mm     | 216   | 108   | 113    | 193   | 42.5    | 69      | 60    | 70    | 70    | 8.4 kg   |

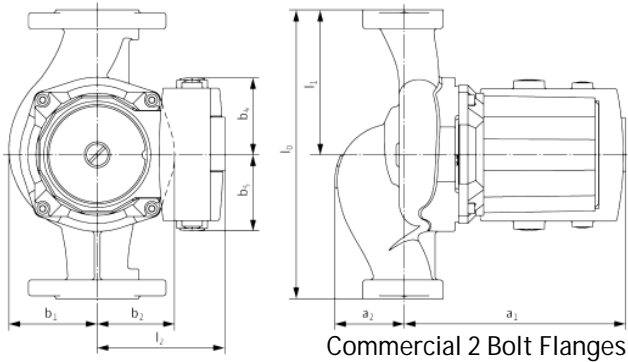

| Speed | RPM  | Max Watts | Amps 208/3 V | Amps 230/3 V |
|-------|------|-----------|--------------|--------------|
| Max   | 3310 | 355       | 1.3          | 1.3          |
| Min   | 2840 | 245       | 0.8          | 0.8          |

|                   |                  |                    |
|-------------------|------------------|--------------------|
| 140 deg F (60 C)  | 194 deg F (90 C) | Min Inlet Pressure |
| 1.8 PSI ( 12 kpa) | 7.3 PSI (50 kpa) |                    |

### Operating Limits

Max Temp 14 to 248 Deg F (- 10 to 120 Deg C)  
 Max Ambient Temp 104 Deg F (40 Deg C)  
 Max Working Pressure 145 PSI (10 Bar)

### Materials of Construction

Impeller Polypropylene (50% Glass Filled)  
 Shaft Stainless Steel (X40 Cr13)  
 Bearing Metal Impregnated Carbon  
 Volute Cast Iron (Closed Systems)  
 Cataphoresis Coated

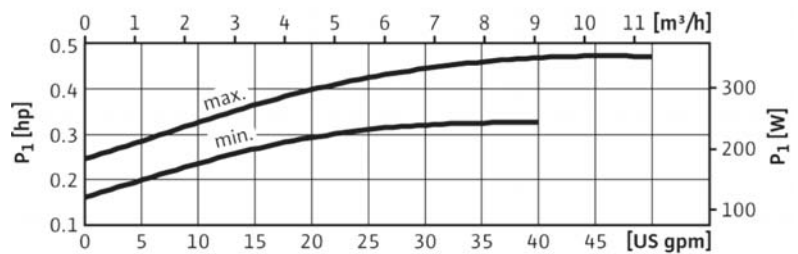
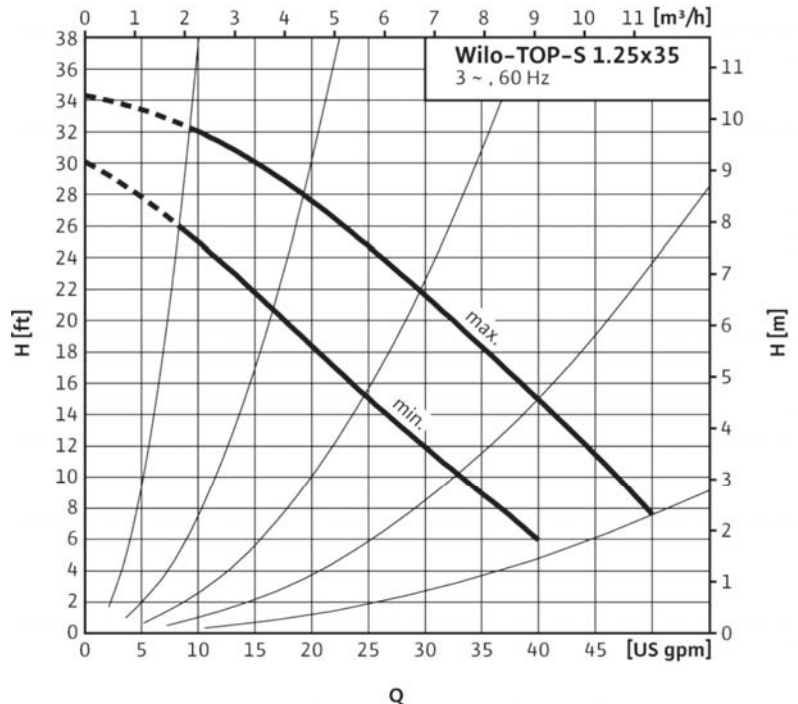

Wilo USA LLC  
 1290 North 25th Avenue  
 Melrose Park, Illinois 60160  
 Phone: 866 945 6872 Fax: 708 338 9455  
 www.wilo-na.com

Wilo Canada Inc  
 Bay 7 - 2915 - 10th Ave N. E.  
 Calgary, Alberta, T2A 5L4  
 Phone: 866 945 6236 Fax: 403 277 9456  
 www.wilo-na.com



# WILO TOP S Submittal

Top S 1.5 x 20 Three Phase Series



Pumpen Intelligenz.

|               |       |
|---------------|-------|
| Project:      |       |
| Engineer:     |       |
| Contractor:   |       |
| Submitted By: | Date: |
| Approved By:  | Date: |

| Tag # | Model #        | Flow | Head | Volt | Phase | Comments |
|-------|----------------|------|------|------|-------|----------|
|       | TOP S 1.5 X 20 |      |      |      | 3     |          |
|       | TOP S 1.5 X 20 |      |      |      | 3     |          |

| Details  | Max Hp   | Pipe Size | l0  | l1     | l2     | a1      | a2    | b1     | b2      | b4    | b5    | Weight   |
|----------|----------|-----------|-----|--------|--------|---------|-------|--------|---------|-------|-------|----------|
| Imperial | 1/4 Hp   | 1 1/2"    | 10  | 5 3/16 | 4 7/16 | 7 11/16 | 2 3/8 | 3 1/16 | 2 11/16 | 2 3/4 | 2 3/4 | 22.0 lbs |
| Metric   | 180 Watt | 40 mm     | 254 | 127    | 113    | 195     | 61    | 78     | 68      | 70    | 70    | 10.0 kg  |

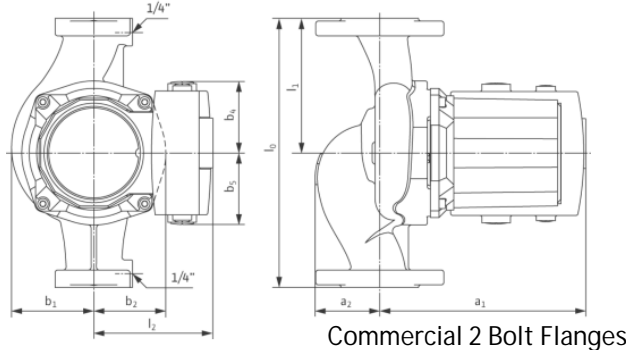

| Speed | RPM  | Max Watts | Amps 208/3 V | Amps 230/3 V |
|-------|------|-----------|--------------|--------------|
| Max   | 3340 | 325       | 1.3          | 1.3          |
| Min   | 2840 | 225       | 0.7          | 0.7          |

|                   |                  |                    |
|-------------------|------------------|--------------------|
| 140 deg F (60 C)  | 194 deg F (90 C) | Min Inlet Pressure |
| 1.8 PSI ( 12 kpa) | 7.3 PSI (50 kpa) |                    |

**Operating Limits**  
 Max Temp 14 to 248 Deg F (- 10 to 120 Deg C)  
 Max Ambient Temp 104 Deg F (40 Deg C)  
 Max Working Pressure 145 PSI (10 Bar)

**Materials of Construction**  
 Impeller Polypropylene (50% Glass Filled)  
 Shaft Stainless Steel (X40 Cr13)  
 Bearing Metal Impregnated Carbon  
 Volute Cast Iron (Closed Systems)  
 Cataphoresis Coated  
 Bronze Available (B Model)

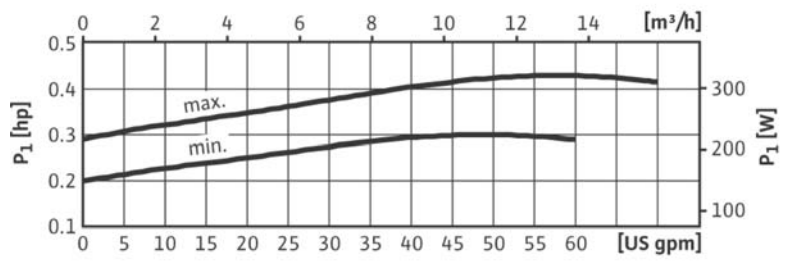
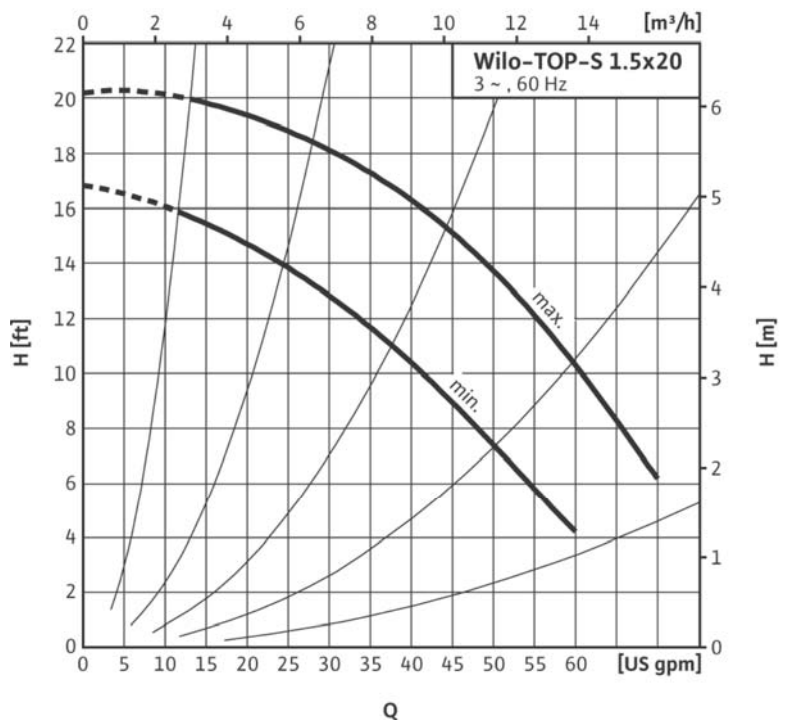

Wilo USA LLC  
 1290 North 25th Avenue  
 Melrose Park, Illinois 60160  
 Phone: 866 945 6872 Fax: 708 338 0455  
 www.wilo-na.com

Wilo Canada Inc  
 Bay 7 - 2915 - 10th Ave N. E.  
 Calgary, Alberta, T2A 5L4  
 Phone: 866 945 6236 Fax: 403 277 9456  
 www.wilo-na.com



# WILO TOP S Submittal

Top S 1.5 x 30 Three Phase Series



Pumpen Intelligenz.

|               |       |
|---------------|-------|
| Project:      |       |
| Engineer:     |       |
| Contractor:   |       |
| Submitted By: | Date: |
| Approved By:  | Date: |

| Tag # | Model #        | Flow | Head | Volt | Phase | Comments |
|-------|----------------|------|------|------|-------|----------|
|       | TOP S 1.5 X 30 |      |      |      | 3     |          |
|       | TOP S 1.5 X 30 |      |      |      | 3     |          |

| Details  | Max Hp   | Pipe Size | l0  | l1  | l2    | a1    | a2     | b1     | b2    | b4    | b5    | Weight   |
|----------|----------|-----------|-----|-----|-------|-------|--------|--------|-------|-------|-------|----------|
| Imperial | 1/2 Hp   | 1 1/2"    | 10  | 5   | 4 3/4 | 9 1/4 | 2 5/16 | 3 9/16 | 3 1/8 | 2 3/4 | 2 3/4 | 29.5 lbs |
| Metric   | 350 Watt | 40 mm     | 254 | 127 | 120   | 235   | 58     | 90     | 79    | 70    | 70    | 13.4 kg  |

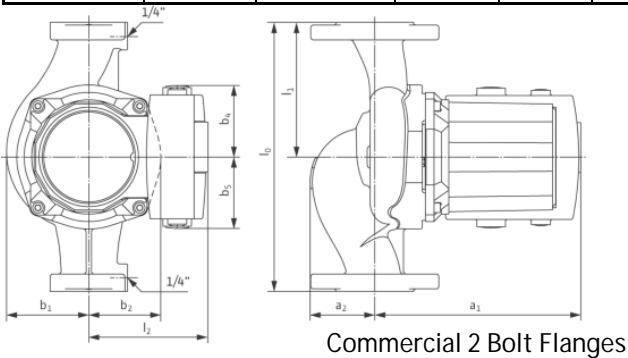

| Speed | RPM  | Max Watts | Amps 208/230 V | 460 V | 575 V |
|-------|------|-----------|----------------|-------|-------|
| Max   | 3390 | 595       | 2.1            | 1.0   | 0.8   |
| Min   | 2990 | 445       | 1.4            | 0.7   | 0.5   |

|                   |                  |                    |
|-------------------|------------------|--------------------|
| 140 deg F (60 C)  | 194 deg F (90 C) | Min Inlet Pressure |
| 1.8 PSI ( 12 kpa) | 7.3 PSI (50 kpa) |                    |

### Operating Limits

Max Temp 14 to 248 Deg F (- 10 to 120 Deg C)  
 Max Ambient Temp 104 Deg F (40 Deg C)  
 Max Working Pressure 145 PSI (10 Bar)

### Materials of Construction

Impeller Polypropylene (50% Glass Filled)  
 Shaft Stainless Steel (X40 Cr13)  
 Bearing Metal Impregnated Carbon  
 Volute Cast Iron (Closed Systems)  
 Cataphoresis Coated  
 Bronze Available (B Model)

Wilo USA LLC

1290 North 25th Avenue

Melrose Park, Illinois 60160

Phone: 866 945 6872

Fax: 708 338 0455

www.wilo-na.com

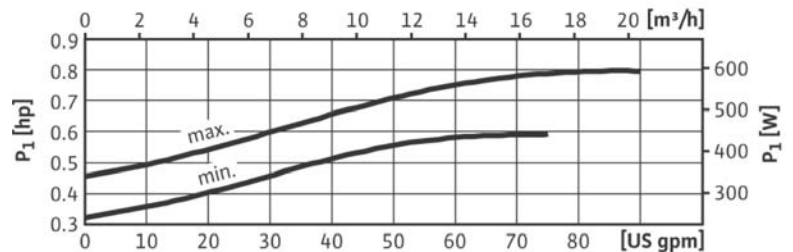
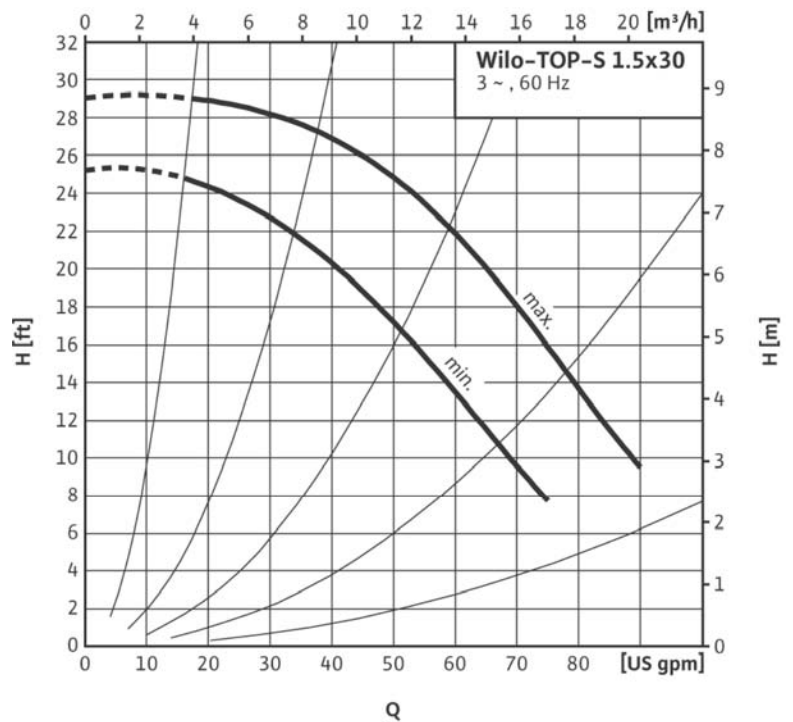

Wilo Canada Inc  
 Bay 7 - 2915 - 10th Ave N. E.  
 Calgary, Alberta, T2A 5L4  
 Phone: 866 945 6236 Fax: 403 277 9456  
 www.wilo-na.com





# WILO TOP S Submittal

Top S 1.5 x 40 Three Phase Series



Pumpen Intelligenz.

|               |       |
|---------------|-------|
| Project:      |       |
| Engineer:     |       |
| Contractor:   |       |
| Submitted By: | Date: |
| Approved By:  | Date: |

| Tag # | Model #        | Flow | Head | Volt | Phase | Comments |
|-------|----------------|------|------|------|-------|----------|
|       | TOP S 1.5 X 40 |      |      |      | 3     |          |
|       | TOP S 1.5 X 40 |      |      |      | 3     |          |

| Details  | Max Hp   | Pipe Size | l0  | l1  | l2    | a1    | a2     | b1     | b2    | b4    | b5    | Weight   |
|----------|----------|-----------|-----|-----|-------|-------|--------|--------|-------|-------|-------|----------|
| Imperial | 5/8 Hp   | 1 1/2"    | 10  | 5   | 4 3/4 | 9 1/4 | 2 5/16 | 3 9/16 | 3 1/8 | 2 3/4 | 2 3/4 | 30.9 lbs |
| Metric   | 450 Watt | 40 mm     | 254 | 127 | 120   | 235   | 58     | 90     | 79    | 70    | 70    | 14.0 kg  |

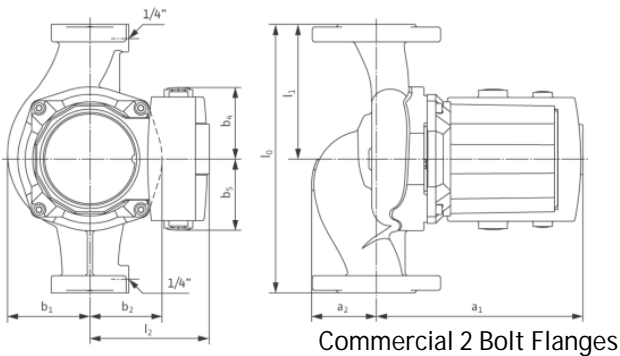

| Speed | RPM  | Max Watts | Amps 208/230 V | 460 V | 575 V |
|-------|------|-----------|----------------|-------|-------|
| Max   | 3330 | 870       | 3.0            | 1.5   | 1.2   |
| Min   | 2890 | 615       | 1.9            | 0.9   | 0.7   |

| 140 deg F (60 C)  | 194 deg F (90 C) | Min Inlet Pressure |
|-------------------|------------------|--------------------|
| 1.8 PSI ( 12 kpa) | 7.3 PSI (50 kpa) |                    |

### Operating Limits

Max Temp 14 to 248 Deg F (- 10 to 120 Deg C)  
 Max Ambient Temp 104 Deg F (40 Deg C)  
 Max Working Pressure 145 PSI (10 Bar)

### Materials of Construction

Impeller Polypropylene (50% Glass Filled)  
 Shaft Stainless Steel (X40 Cr13)  
 Bearing Metal Impregnated Carbon  
 Volute Cast Iron (Closed Systems)  
 Cataphoresis Coated  
 Bronze Available (B Model)

Wilco USA LLC

1290 North 25th Avenue

Melrose Park, Illinois 60160

Phone: 866 945 6872 Fax: 708 338 0455

www.wilo-na.com

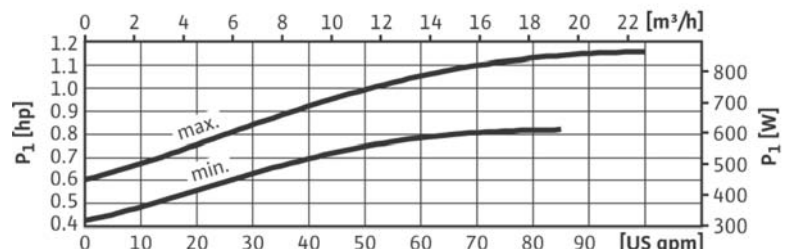
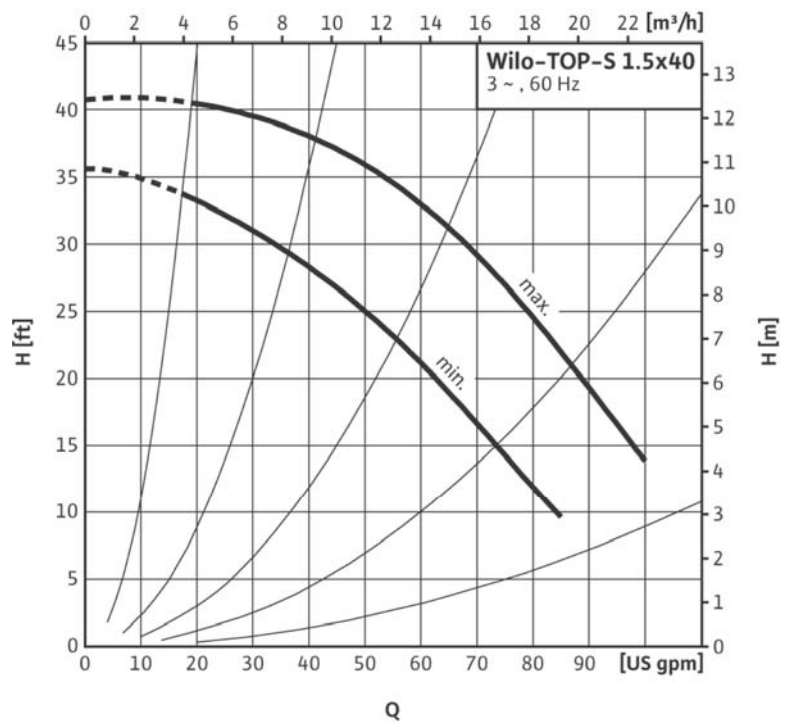

Wilco Canada Inc

Bay 7 - 2915 - 10th Ave N. E.

Calgary, Alberta, T2A 5L4

Phone: 866 945 6236 Fax: 403 277 9456

www.wilo-na.com



# WILO TOP S Submittal

## Top S 1.5 x 50 Three Phase Series



|               |       |
|---------------|-------|
| Project:      |       |
| Engineer:     |       |
| Contractor:   |       |
| Submitted By: | Date: |
| Approved By:  | Date: |

| Tag # | Model #        | Flow | Head | Volt | Phase | Comments |
|-------|----------------|------|------|------|-------|----------|
|       | TOP S 1.5 X 50 |      |      |      | 3     |          |
|       | TOP S 1.5 X 50 |      |      |      | 3     |          |

| Details  | Max Hp   | Pipe Size | l0  | l1  | l2    | a1     | a2    | b1    | b2    | b4    | b6    | Weight   |
|----------|----------|-----------|-----|-----|-------|--------|-------|-------|-------|-------|-------|----------|
| Imperial | 3/4 Hp   | 1 1/2"    | 10  | 5   | 5 1/8 | 10 7/8 | 2 1/8 | 3 7/8 | 3 3/8 | 2 3/4 | 2 3/4 | 43.4 lbs |
| Metric   | 570 Watt | 40 mm     | 254 | 127 | 130   | 277    | 54    | 99    | 86    | 70    | 70    | 19.7 kg  |

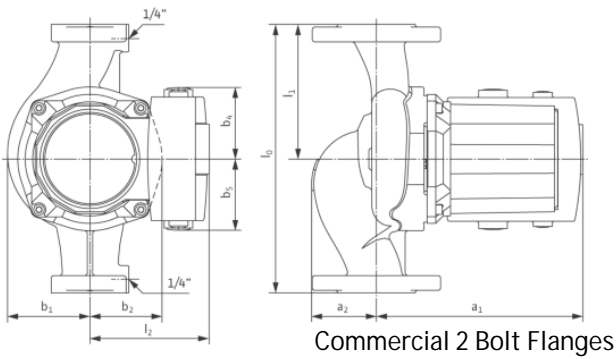

| Speed | RPM  | Max Watts | Amps 208/230 V | 460 V | 575 V |
|-------|------|-----------|----------------|-------|-------|
| Max   | 3380 | 1040      | 3.6            | 1.8   | 1.4   |
| Min   | 2970 | 775       | 2.4            | 1.2   | 0.9   |

|                   |                  |                    |
|-------------------|------------------|--------------------|
| 140 deg F (60 C)  | 194 deg F (90 C) | Min Inlet Pressure |
| 1.8 PSI ( 12 kpa) | 7.3 PSI (50 kpa) |                    |

### Operating Limits

Max Temp 14 to 248 Deg F (- 10 to 120 Deg C)  
 Max Ambient Temp 104 Deg F (40 Deg C)  
 Max Working Pressure 145 PSI (10 Bar)

### Materials of Construction

Impeller Polypropylene (50% Glass Filled)  
 Shaft Stainless Steel (X40 Cr13)  
 Bearing Metal Impregnated Carbon  
 Volute Cast Iron (Closed Systems)  
 Cataphoresis Coated  
 Bronze Available (B Model)

### Wilco USA LLC

1290 North 25th Avenue  
 Melrose Park, Illinois 60160  
 Phone: 866 945 6872 Fax: 708 338 0455  
 www.wilo-na.com

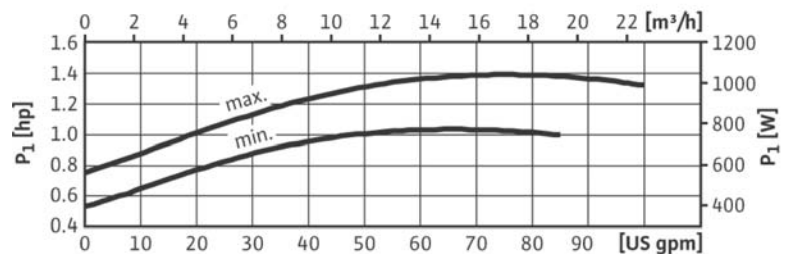
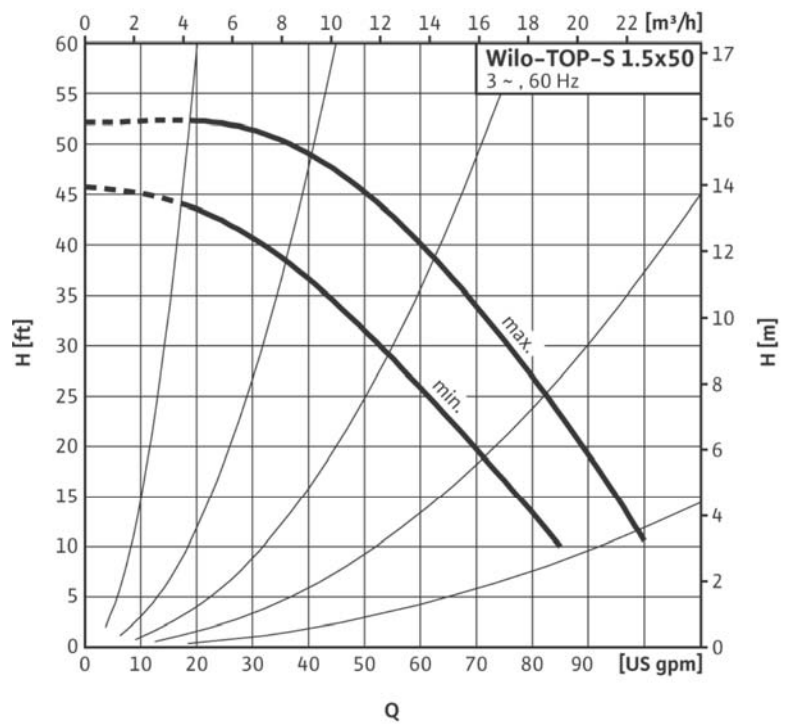

### Wilco Canada Inc

Bay 7 - 2915 - 10th Ave N. E.  
 Calgary, Alberta, T2A 5L4  
 Phone: 866 945 6236 Fax: 403 277 9456  
 www.wilo-na.com



# WILO TOP S Submittal

Top S 1.5 x 70 Three Phase Series



Pumpen Intelligenz.

|               |       |
|---------------|-------|
| Project:      |       |
| Engineer:     |       |
| Contractor:   |       |
| Submitted By: | Date: |
| Approved By:  | Date: |

| Tag # | Model #        | Flow | Head | Volt | Phase | Comments |
|-------|----------------|------|------|------|-------|----------|
|       | TOP S 1.5 X 70 |      |      |      | 3     |          |
|       | TOP S 1.5 X 70 |      |      |      | 3     |          |

| Details  | Max Hp    | Pipe Size | l0  | l1  | l2    | a1     | a2    | b1    | b2    | b4    | b6    | Weight   |
|----------|-----------|-----------|-----|-----|-------|--------|-------|-------|-------|-------|-------|----------|
| Imperial | 1 1/2 Hp  | 1 1/2"    | 10  | 5   | 5 1/8 | 10 7/8 | 2 1/8 | 3 7/8 | 3 3/8 | 2 3/4 | 2 3/4 | 48.1 lbs |
| Metric   | 1100 Watt | 40 mm     | 254 | 127 | 130   | 277    | 54    | 86    | 86    | 70    | 70    | 21.8 kg  |

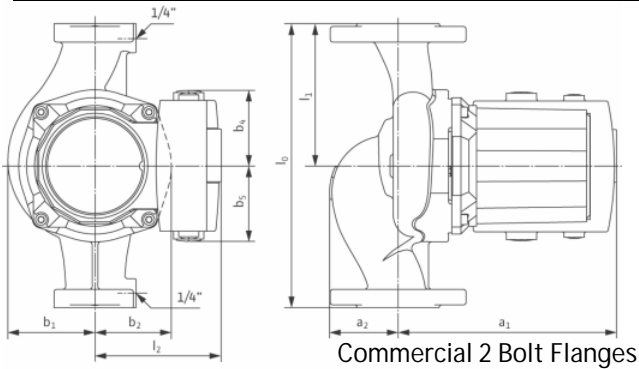

| Speed | RPM  | Max Watts | Amps 208/230 V | 460 V | 575 V |
|-------|------|-----------|----------------|-------|-------|
| Max   | 3410 | 1505      | 5.3            | 2.6   | 2.1   |
| Min   | 3050 | 1125      | 3.5            | 1.7   | 1.4   |

|                   |                  |                    |
|-------------------|------------------|--------------------|
| 140 deg F (60 C)  | 194 deg F (90 C) | Min Inlet Pressure |
| 1.8 PSI ( 12 kpa) | 7.3 PSI (50 kpa) |                    |

### Operating Limits

Max Temp 14 to 248 Deg F (- 10 to 120 Deg C)  
 Max Ambient Temp 104 Deg F (40 Deg C)  
 Max Working Pressure 145 PSI (10 Bar)

### Materials of Construction

Impeller Polypropylene (50% Glass Filled)  
 Shaft Stainless Steel (X40 Cr13)  
 Bearing Metal Impregnated Carbon  
 Volute Cast Iron (Closed Systems)  
 Cataphoresis Coated

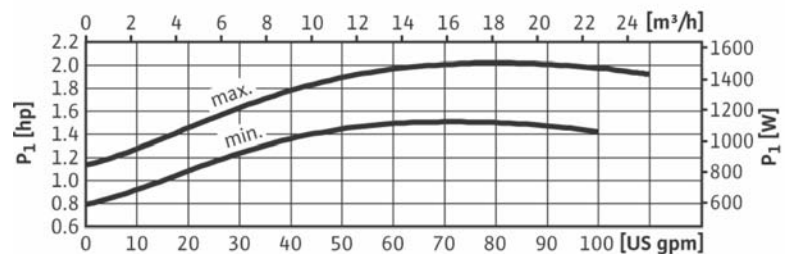
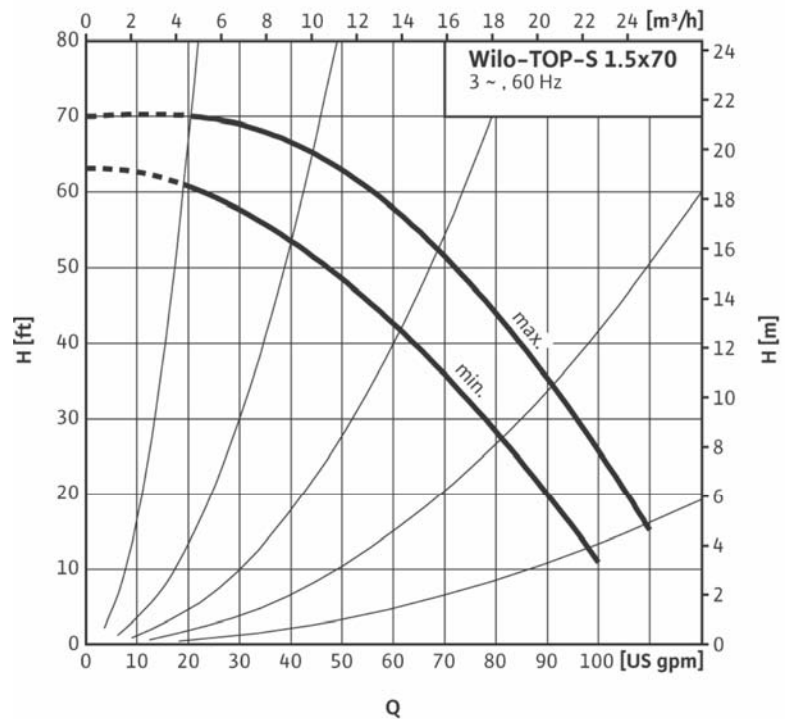

Wilo USA LLC  
 1290 North 25th Avenue  
 Melrose Park, Illinois 60160  
 Phone: 866 945 6872 Fax: 708 338 9455  
 www.wilo-na.com

Wilo Canada Inc  
 Bay 7 - 2915 - 10th Ave N. E.  
 Calgary, Alberta, T2A 5L4  
 Phone: 866 945 6236 Fax: 403 277 9456  
 www.wilo-na.com



# WILO TOP S Submittal

Top S 2.0 x 25 Three Phase Series



Pumpen Intelligenz.

|               |       |
|---------------|-------|
| Project:      |       |
| Engineer:     |       |
| Contractor:   |       |
| Submitted By: | Date: |
| Approved By:  | Date: |

| Tag # | Model #        | Flow | Head | Volt | Phase | Comments |
|-------|----------------|------|------|------|-------|----------|
|       | TOP S 2.0 X 25 |      |      |      | 3     |          |
|       | TOP S 2.0 X 25 |      |      |      | 3     |          |

| Details  | Max Hp   | Pipe Size | l0  | l1    | l2    | a1     | a2    | b1     | b2 | b4    | b6    | Weight   |
|----------|----------|-----------|-----|-------|-------|--------|-------|--------|----|-------|-------|----------|
| Imperial | 1/2 Hp   | 2"        | 11  | 5 1/2 | 4 3/4 | 9 9/16 | 2 1/2 | 3 9/16 | 3  | 2 3/4 | 2 3/4 | 34.8 lbs |
| Metric   | 350 Watt | 50 mm     | 279 | 139.5 | 120   | 243    | 64    | 91     | 76 | 70    | 70    | 15.8 kg  |

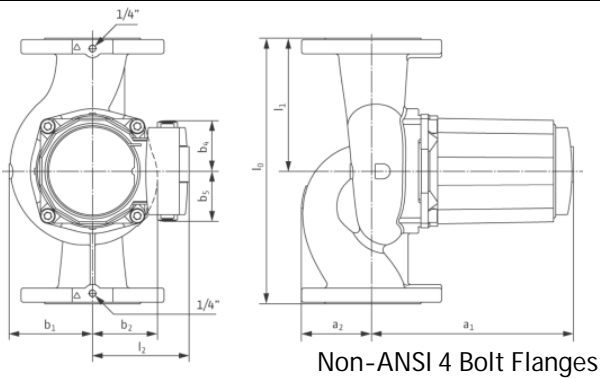

| Speed | RPM  | Max Watts | Amps 208/230 V | 460 V | 575 V |
|-------|------|-----------|----------------|-------|-------|
| Max   | 3380 | 610       | 2.1            | 1.1   | 0.8   |
| Min   | 2950 | 455       | 1.4            | 0.7   | 0.6   |

|                   |                    |                    |
|-------------------|--------------------|--------------------|
| 140 deg F (60 C)  | 194 deg F (90 C)   | Min Inlet Pressure |
| 6.3 PSI ( 43 kpa) | 15.4 PSI (105 kpa) |                    |

### Operating Limits

Max Temp 14 to 248 Deg F (- 10 to 120 Deg C)  
 Max Ambient Temp 104 Deg F (40 Deg C)  
 Max Working Pressure 145 PSI (10 Bar)

### Materials of Construction

Impeller Polypropylene (50% Glass Filled)  
 Shaft Stainless Steel (X40 Cr13)  
 Bearing Metal Impregnated Carbon  
 Volute Cast Iron (Closed Systems)  
 Cataphoresis Coated  
 Bronze Available (B Model)

Wilo USA LLC

1290 North 25th Avenue

Melrose Park, Illinois 60160

Phone: 866 945 6872

Fax: 708 338 0455

www.wilo-na.com

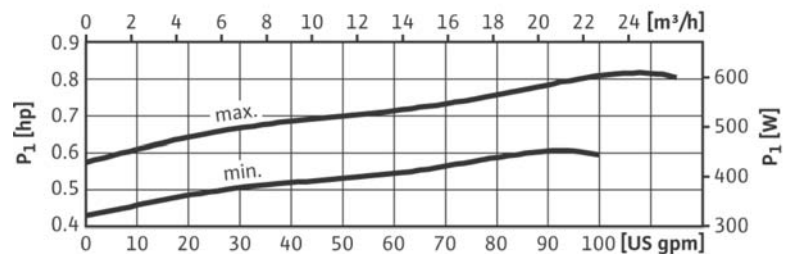
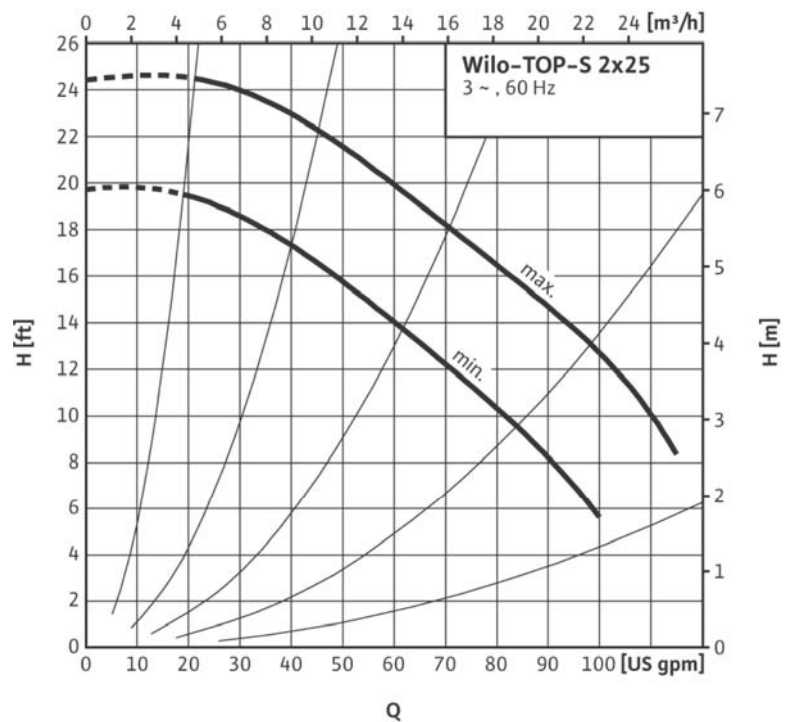

Wilo Canada Inc

Bay 7 - 2915 - 10th Ave N. E.

Calgary, Alberta, T2A 5L4

Phone: 866 945 6236

Fax: 403 277 9456

www.wilo-na.com



# WILO TOP S Submittal

Top S 2.0 x 35 Three Phase Series



Pumpen Intelligenz.

|               |       |
|---------------|-------|
| Project:      |       |
| Engineer:     |       |
| Contractor:   |       |
| Submitted By: | Date: |
| Approved By:  | Date: |

| Tag # | Model #        | Flow | Head | Volt | Phase | Comments |
|-------|----------------|------|------|------|-------|----------|
|       | TOP S 2.0 X 35 |      |      |      | 3     |          |
|       | TOP S 2.0 X 35 |      |      |      | 3     |          |

| Details  | Max Hp   | Pipe Size | l0  | l1    | l2    | a1     | a2    | b1     | b2 | b4    | b6    | Weight   |
|----------|----------|-----------|-----|-------|-------|--------|-------|--------|----|-------|-------|----------|
| Imperial | 5/8 Hp   | 2"        | 11  | 5 1/2 | 4 3/4 | 9 9/16 | 2 1/2 | 3 9/16 | 3  | 2 3/4 | 2 3/4 | 36.8 lbs |
| Metric   | 450 Watt | 50 mm     | 279 | 139.5 | 120   | 243    | 64    | 91     | 76 | 70    | 70    | 16.7 kg  |

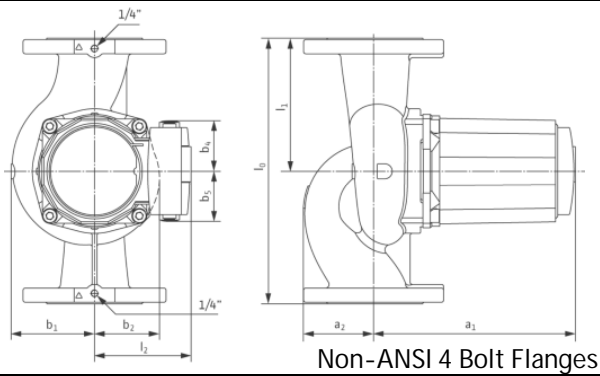

| Speed | RPM  | Max Watts | Amps 208/230 V | 460 V | 575 V |
|-------|------|-----------|----------------|-------|-------|
| Max   | 3330 | 870       | 3.0            | 1.5   | 1.2   |
| Min   | 2870 | 615       | 1.9            | 0.9   | 0.8   |

|                   |                    |                    |
|-------------------|--------------------|--------------------|
| 140 deg F (60 C)  | 194 deg F (90 C)   | Min Inlet Pressure |
| 6.3 PSI ( 43 kpa) | 15.4 PSI (105 kpa) |                    |

### Operating Limits

Max Temp 14 to 248 Deg F (- 10 to 120 Deg C)  
 Max Ambient Temp 104 Deg F (40 Deg C)  
 Max Working Pressure 145 PSI (10 Bar)

### Materials of Construction

Impeller Polypropylene (50% Glass Filled)  
 Shaft Stainless Steel (X40 Cr13)  
 Bearing Metal Impregnated Carbon  
 Volute Cast Iron (Closed Systems)  
 Cataphoresis Coated  
 Bronze Available (B Model)

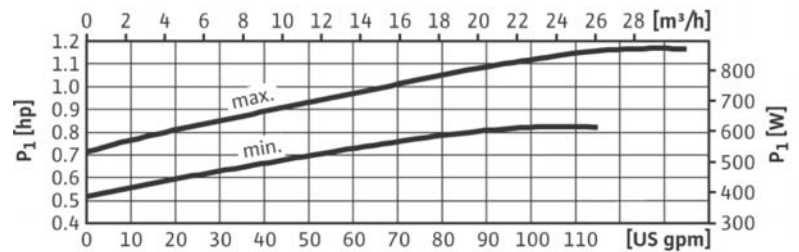
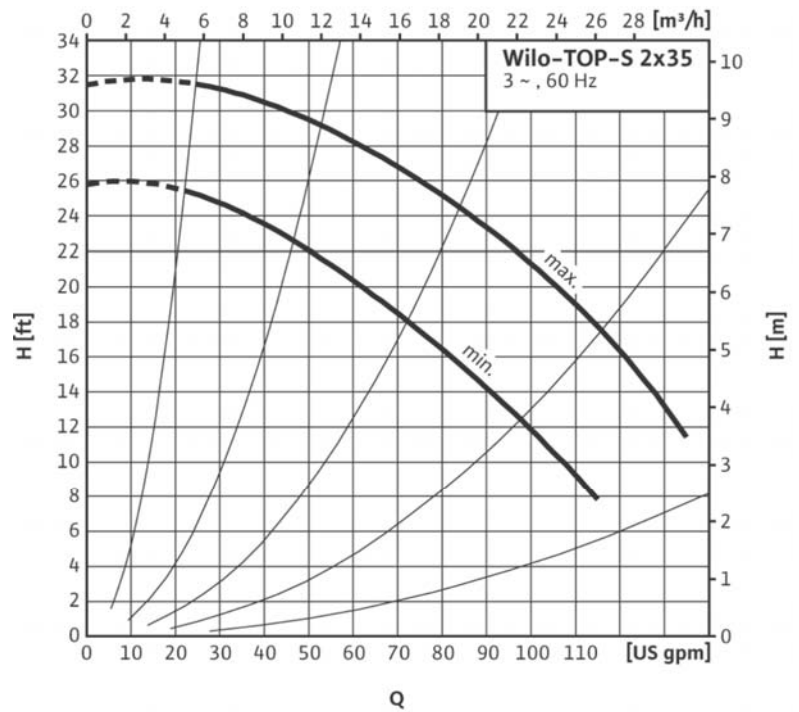

Wilo USA LLC  
 1290 North 25th Avenue  
 Melrose Park, Illinois 60160  
 Phone: 866 945 6872 Fax: 708 338 0455  
 www.wilo-na.com

Wilo Canada Inc  
 Bay 7 - 2915 - 10th Ave N. E.  
 Calgary, Alberta, T2A 5L4  
 Phone: 866 945 6236 Fax: 403 277 9456  
 www.wilo-na.com



# WILO TOP S Submittal

Top S 2.0 x 40 Three Phase Series



Pumpen Intelligenz.

|               |       |
|---------------|-------|
| Project:      |       |
| Engineer:     |       |
| Contractor:   |       |
| Submitted By: | Date: |
| Approved By:  | Date: |

| Tag # | Model #        | Flow | Head | Volt | Phase | Comments |
|-------|----------------|------|------|------|-------|----------|
|       | TOP S 2.0 X 40 |      |      |      | 3     |          |
|       | TOP S 2.0 X 40 |      |      |      | 3     |          |

| Details  | Max Hp   | Pipe Size | l0  | l1    | l2    | a1     | a2    | b1  | b2    | b4    | b6    | Weight   |
|----------|----------|-----------|-----|-------|-------|--------|-------|-----|-------|-------|-------|----------|
| Imperial | 3/4 Hp   | 2"        | 11  | 5 1/2 | 5 1/8 | 10 3/8 | 2 3/4 | 4   | 3 3/8 | 2 3/4 | 2 3/4 | 46.1 lbs |
| Metric   | 570 Watt | 50 mm     | 279 | 139.5 | 130   | 263    | 70    | 101 | 86    | 70    | 70    | 20.9 kg  |

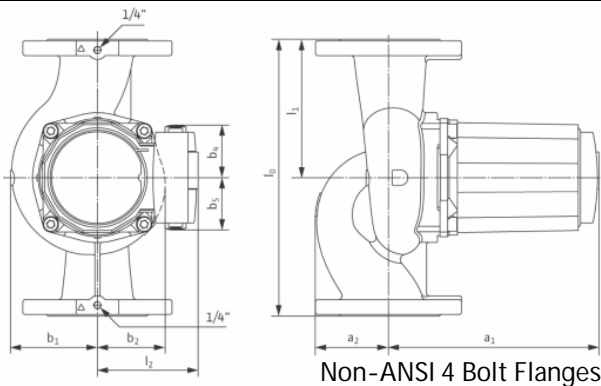

| Speed | RPM  | Max Watts | Amps 208/230 V | 460 V | 575 V |
|-------|------|-----------|----------------|-------|-------|
| Max   | 3380 | 995       | 3.5            | 1.7   | 1.4   |
| Min   | 2940 | 740       | 2.3            | 1.1   | 0.9   |

|                   |                    |                    |
|-------------------|--------------------|--------------------|
| 140 deg F (60 C)  | 194 deg F (90 C)   | Min Inlet Pressure |
| 6.3 PSI ( 43 kpa) | 15.4 PSI (105 kpa) |                    |

**Operating Limits**

Max Temp 14 to 248 Deg F (- 10 to 120 Deg C)  
 Max Ambient Temp 104 Deg F (40 Deg C)  
 Max Working Pressure 145 PSI (10 Bar)

**Materials of Construction**

Impeller Polypropylene (50% Glass Filled)  
 Shaft Stainless Steel (X40 Cr13)  
 Bearing Metal Impregnated Carbon  
 Volute Cast Iron (Closed Systems)  
 Cataphoresis Coated

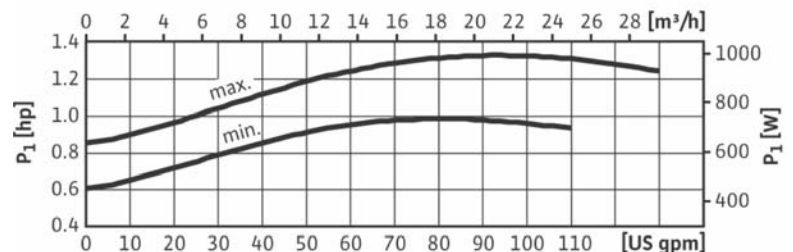
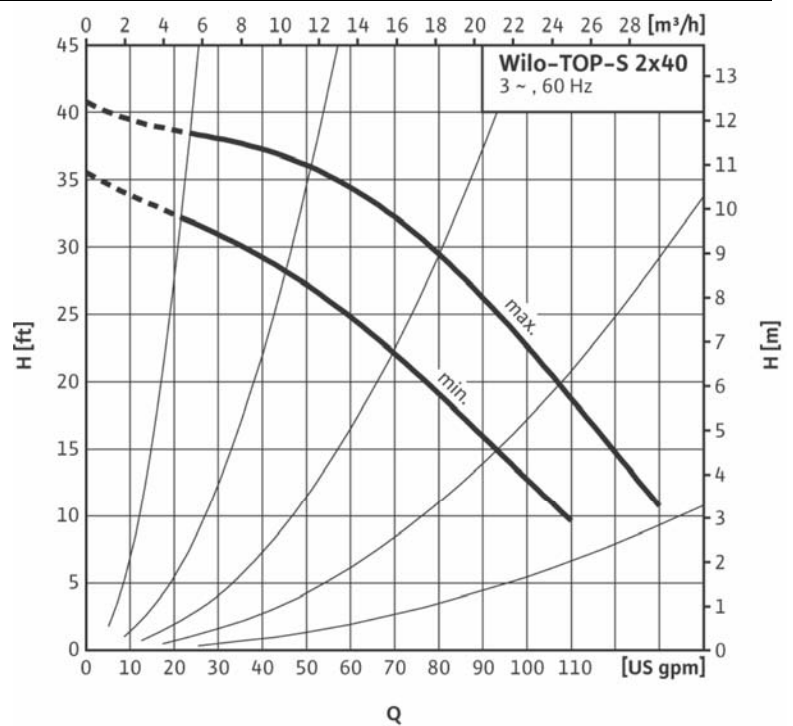

Wilo USA LLC  
 1290 North 25th Avenue  
 Melrose Park, Illinois 60160  
 Phone: 866 945 6872 Fax: 708 338 9455  
 www.wilo-na.com

Wilo Canada Inc  
 Bay 7 - 2915 - 10th Ave N. E.  
 Calgary, Alberta, T2A 5L4  
 Phone: 866 945 6236 Fax: 403 277 9456  
 www.wilo-na.com



# WILO TOP S Submittal

Top S 2.0 x 50 Three Phase Series



Pumpen Intelligenz.

|               |       |
|---------------|-------|
| Project:      |       |
| Engineer:     |       |
| Contractor:   |       |
| Submitted By: | Date: |
| Approved By:  | Date: |

| Tag # | Model #        | Flow | Head | Volt | Phase | Comments |
|-------|----------------|------|------|------|-------|----------|
|       | TOP S 2.0 X 50 |      |      |      | 3     |          |
|       | TOP S 2.0 X 50 |      |      |      | 3     |          |

| Details  | Max Hp    | Pipe Size | l0     | l1    | l2    | a1      | a2     | b1    | b2     | b4    | b6    | Weight   |
|----------|-----------|-----------|--------|-------|-------|---------|--------|-------|--------|-------|-------|----------|
| Imperial | 1 1/2 Hp  | 2"        | 13 1/2 | 6 3/4 | 5 1/8 | 11 7/16 | 3 7/16 | 4 1/8 | 3 9/16 | 2 3/4 | 2 3/4 | 54.5 lbs |
| Metric   | 1100 Watt | 50 mm     | 343    | 171.5 | 130   | 290     | 88     | 105   | 90     | 70    | 70    | 24.7 kg  |

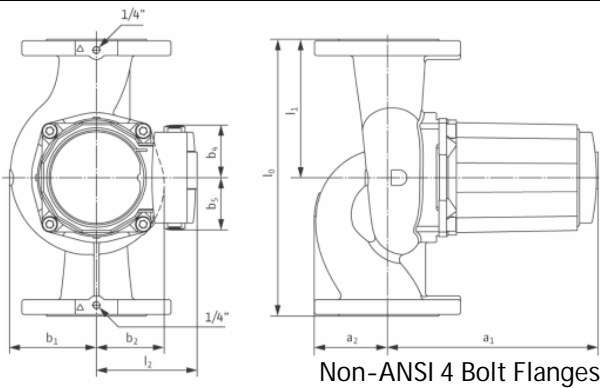

| Speed | RPM  | Max Watts | Amps 208/230 V | 460 V | 575 V |
|-------|------|-----------|----------------|-------|-------|
| Max   | 3420 | 1480      | 5.2            | 2.6   | 2.1   |
| Min   | 3080 | 1105      | 3.4            | 1.7   | 1.4   |

|                   |                    |                    |
|-------------------|--------------------|--------------------|
| 140 deg F (60 C)  | 194 deg F (90 C)   | Min Inlet Pressure |
| 6.3 PSI ( 43 kpa) | 15.4 PSI (105 kpa) |                    |

**Operating Limits**

Max Temp 14 to 248 Deg F (- 10 to 120 Deg C)  
 Max Ambient Temp 104 Deg F (40 Deg C)  
 Max Working Pressure 145 PSI (10 Bar)

**Materials of Construction**

Impeller Polypropylene (50% Glass Filled)  
 Shaft Stainless Steel (X40 Cr13)  
 Bearing Metal Impregnated Carbon  
 Volute Cast Iron (Closed Systems)  
 Cataphoresis Coated

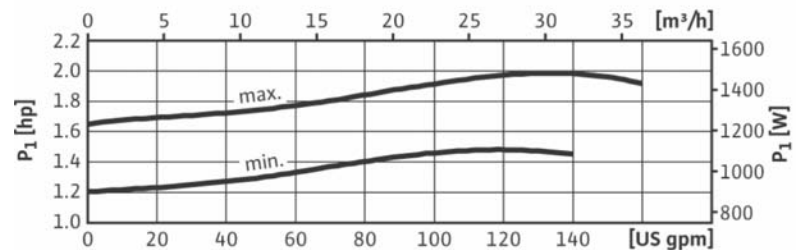
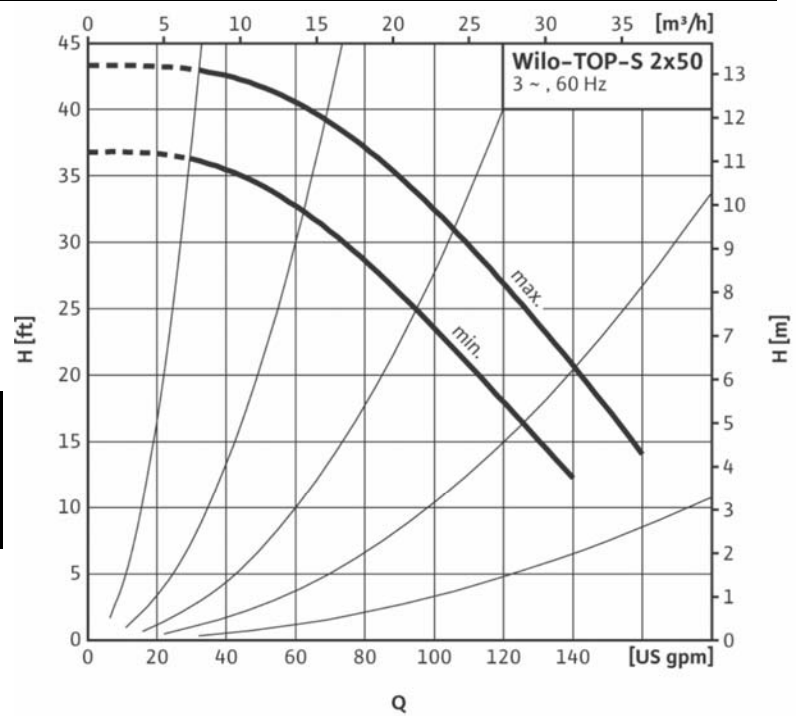

Wilo USA LLC  
 1290 North 25th Avenue  
 Melrose Park, Illinois 60160  
 Phone: 866 945 6872 Fax: 708 338 0455  
 www.wilo-na.com

Wilo Canada Inc  
 Bay 7 - 2915 - 10th Ave N. E.  
 Calgary, Alberta, T2A 5L4  
 Phone: 866 945 6236 Fax: 403 277 9456  
 www.wilo-na.com



# WILO TOP S Submittal

Top S 2.0 x 60 Three Phase Series



Pumpen Intelligenz.

|               |       |
|---------------|-------|
| Project:      |       |
| Engineer:     |       |
| Contractor:   |       |
| Submitted By: | Date: |
| Approved By:  | Date: |

| Tag # | Model #        | Flow | Head | Volt | Phase | Comments |
|-------|----------------|------|------|------|-------|----------|
|       | TOP S 2.0 X 60 |      |      |      | 3     |          |
|       | TOP S 2.0 X 60 |      |      |      | 3     |          |

| Details  | Max Hp    | Pipe Size | l0     | l1    | l2    | a1      | a2     | b1    | b2     | b4    | b6    | Weight   |
|----------|-----------|-----------|--------|-------|-------|---------|--------|-------|--------|-------|-------|----------|
| Imperial | 1 3/4 Hp  | 2"        | 13 1/2 | 6 3/4 | 5 1/8 | 11 7/16 | 3 7/16 | 4 1/8 | 3 9/16 | 2 3/4 | 2 3/4 | 60.4 lbs |
| Metric   | 1300 Watt | 50 mm     | 343    | 171.5 | 130   | 290     | 88     | 105   | 90     | 70    | 70    | 27.4 kg  |

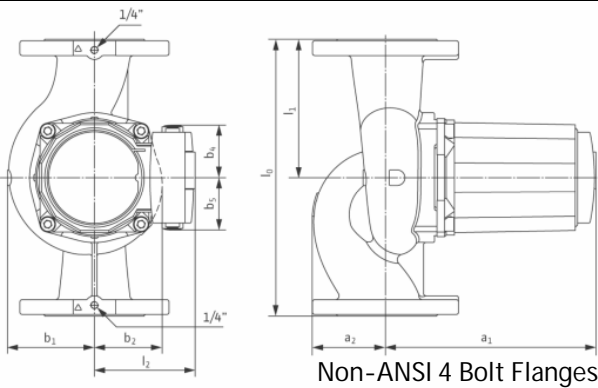

| Speed | RPM  | Max Watts | Amps 208/230 V | 460 V | 575 V |
|-------|------|-----------|----------------|-------|-------|
| Max   | 3460 | 2035      | 6.8            | 3.4   | 2.7   |
| Min   | 3180 | 1630      | 4.9            | 2.4   | 2.0   |

|                   |                    |                    |
|-------------------|--------------------|--------------------|
| 140 deg F (60 C)  | 194 deg F (90 C)   | Min Inlet Pressure |
| 6.3 PSI ( 43 kpa) | 15.4 PSI (105 kpa) |                    |

### Operating Limits

Max Temp 14 to 248 Deg F (- 10 to 120 Deg C)  
 Max Ambient Temp 104 Deg F (40 Deg C)  
 Max Working Pressure 145 PSI (10 Bar)

### Materials of Construction

Impeller Polypropylene (50% Glass Filled)  
 Shaft Stainless Steel (X40 Cr13)  
 Bearing Metal Impregnated Carbon  
 Volute Cast Iron (Closed Systems)  
 Cataphoresis Coated

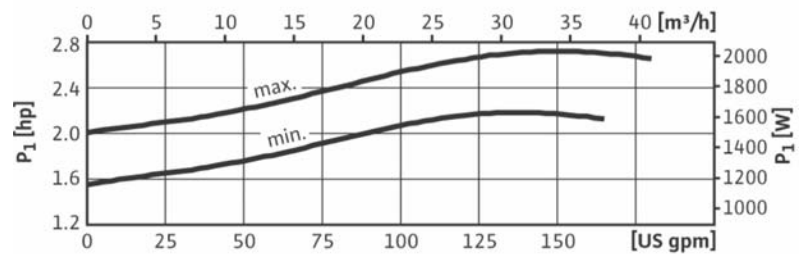
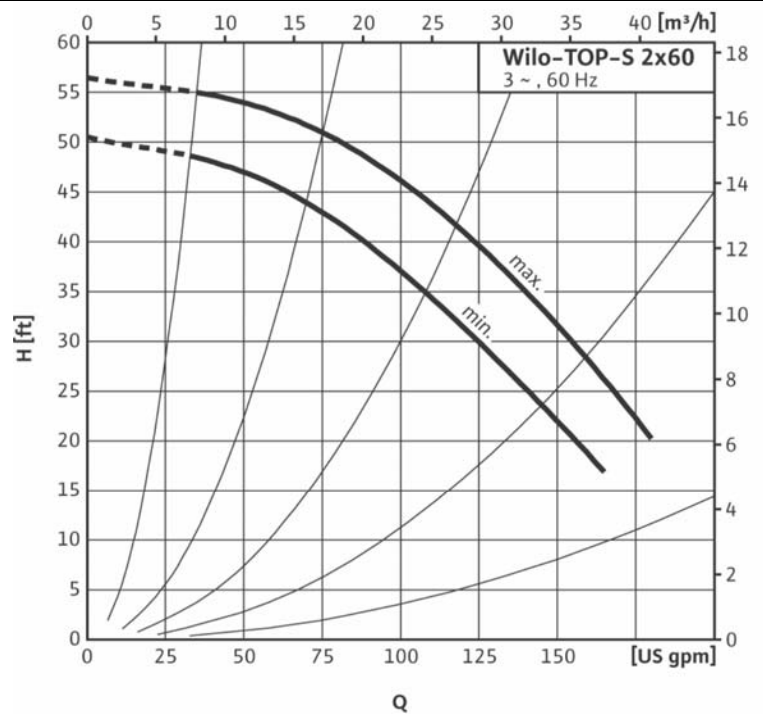

Wilo USA LLC  
 1290 North 25th Avenue  
 Melrose Park, Illinois 60160  
 Phone: 866 945 6872 Fax: 708 338 0455  
 www.wilo-na.com

Wilo Canada Inc  
 Bay 7 - 2915 - 10th Ave N. E.  
 Calgary, Alberta, T2A 5L4  
 Phone: 866 945 6236 Fax: 403 277 9456  
 www.wilo-na.com





# WILO TOP S Submittal

Top S 3.0 x 25 Three Phase Series



Pumpen Intelligenz.

|               |       |
|---------------|-------|
| Project:      |       |
| Engineer:     |       |
| Contractor:   |       |
| Submitted By: | Date: |
| Approved By:  | Date: |

| Tag # | Model #        | Flow | Head | Volt | Phase | Comments |
|-------|----------------|------|------|------|-------|----------|
|       | TOP S 3.0 X 25 |      |      |      | 3     |          |
|       | TOP S 3.0 X 25 |      |      |      | 3     |          |

| Details  | Max Hp   | Pipe Size | l0  | l1  | l2    | a1       | a2      | b1     | b2     | b4    | b6    | Weight   |
|----------|----------|-----------|-----|-----|-------|----------|---------|--------|--------|-------|-------|----------|
| Imperial | 3/4 Hp   | 3"        | 14  | 7   | 5 1/8 | 10 11/16 | 3 11/16 | 4 7/16 | 3 7/16 | 2 3/4 | 2 3/4 | 66.4 lbs |
| Metric   | 570 Watt | 80 mm     | 356 | 178 | 130   | 271      | 94      | 112    | 87     | 70    | 70    | 30.1 kg  |

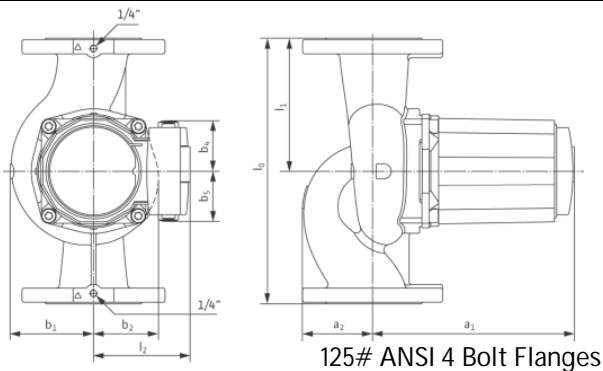

| Speed | RPM  | Max Watts | Amps 208/230 V | 460 V | 575 V |
|-------|------|-----------|----------------|-------|-------|
| Max   | 3340 | 1125      | 3.8            | 1.9   | 1.5   |
| Min   | 2910 | 820       | 2.5            | 1.3   | 1.0   |

| 140 deg F (60 C) | 194 deg F (90 C)   | Min Inlet Pressure |
|------------------|--------------------|--------------------|
| 6.3 PSI (43 kpa) | 15.4 PSI (105 kpa) |                    |

### Operating Limits

Max Temp 14 to 248 Deg F (- 10 to 120 Deg C)  
 Max Ambient Temp 104 Deg F (40 Deg C)  
 Max Working Pressure 145 PSI (10 Bar)

### Materials of Construction

Impeller Polypropylene (50% Glass Filled)  
 Shaft Stainless Steel (X40 Cr13)  
 Bearing Metal Impregnated Carbon  
 Volute Cast Iron (Closed Systems)  
 Cataphoresis Coated  
 Bronze Available (B Model)

Wilo USA LLC

1290 North 25th Avenue

Melrose Park, Illinois 60160

Phone: 866 945 6872

Fax: 708 338 0455

www.wilo-na.com

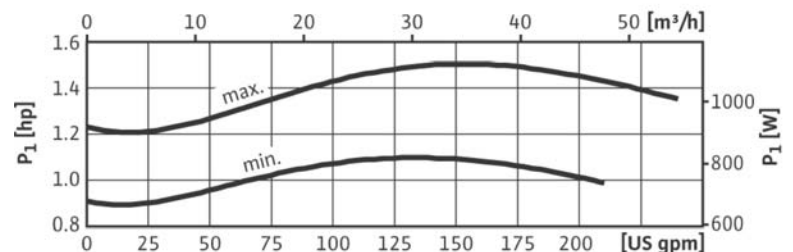
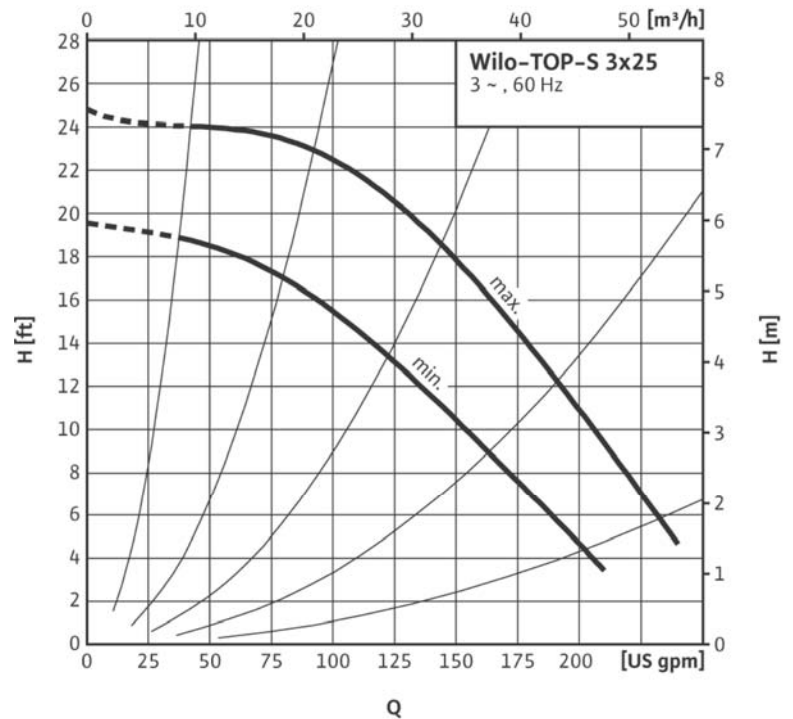

Wilo Canada Inc  
 Bay 7 - 2915 - 10th Ave N. E.  
 Calgary, Alberta, T2A 5L4  
 Phone: 866 945 6236 Fax: 403 277 9456  
 www.wilo-na.com



# WILO TOP S Submittal

Top S 3.0 x 50 Three Phase Series



Pumpen Intelligenz.

|               |       |
|---------------|-------|
| Project:      |       |
| Engineer:     |       |
| Contractor:   |       |
| Submitted By: | Date: |
| Approved By:  | Date: |

| Tag # | Model #        | Flow | Head | Volt | Phase | Comments |
|-------|----------------|------|------|------|-------|----------|
|       | TOP S 3.0 X 50 |      |      |      | 3     |          |
|       | TOP S 3.0 X 50 |      |      |      | 3     |          |

| Details  | Max Hp    | Pipe Size | l0  | l1  | l2     | a1      | a2    | b1      | b2    | b4    | b6    | Weight    |
|----------|-----------|-----------|-----|-----|--------|---------|-------|---------|-------|-------|-------|-----------|
| Imperial | 2 Hp      | 3"        | 14  | 7   | 6 1/16 | 13 1/16 | 6 1/4 | 4 11/16 | 4 1/4 | 2 3/4 | 2 3/4 | 106.3 lbs |
| Metric   | 1600 Watt | 80 mm     | 356 | 178 | 154    | 332     | 159   | 119     | 108   | 70    | 70    | 48.2 kg   |

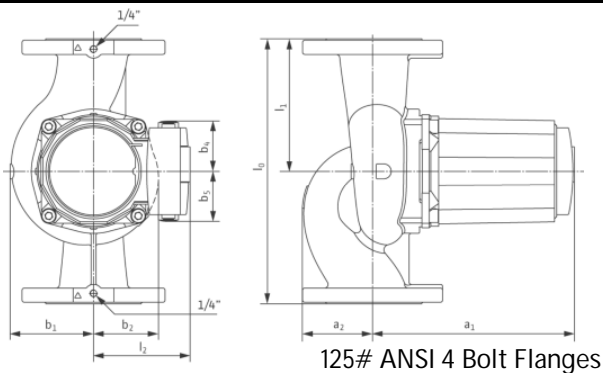

| Speed | RPM  | Max Watts | Amps 208/230 V | 460 V | 575 V |
|-------|------|-----------|----------------|-------|-------|
| Max   | 3510 | 2360      | 8.7            | 4.3   | 3.5   |
| Min   | 3340 | 1835      | 5.7            | 2.9   | 2.3   |

|                   |                    |                    |
|-------------------|--------------------|--------------------|
| 140 deg F (60 C)  | 194 deg F (90 C)   | Min Inlet Pressure |
| 6.3 PSI ( 43 kpa) | 15.4 PSI (105 kpa) |                    |

### Operating Limits

Max Temp 14 to 248 Deg F ( - 10 to 120 Deg C)  
 Max Ambient Temp 104 Deg F (40 Deg C)  
 Max Working Pressure 145 PSI (10 Bar)

### Materials of Construction

Impeller Polypropylene (50% Glass Filled)  
 Shaft Stainless Steel (X40 Cr13)  
 Bearing Metal Impregnated Carbon  
 Volute Cast Iron (Closed Systems)  
 Cataphoresis Coated  
 Bronze Available (B Model)

Wilco USA LLC

1290 North 25th Avenue

Melrose Park, Illinois 60160

Phone: 866 945 6872

Fax: 708 338 0455

www.wilo-na.com

Wilco Canada Inc

Bay 7 - 2915 - 10th Ave N. E.

Calgary, Alberta, T2A 5L4

Phone: 866 945 6236

Fax: 403 277 9456

www.wilo-na.com

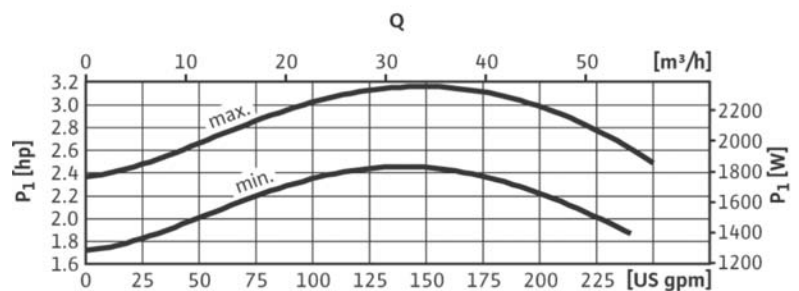
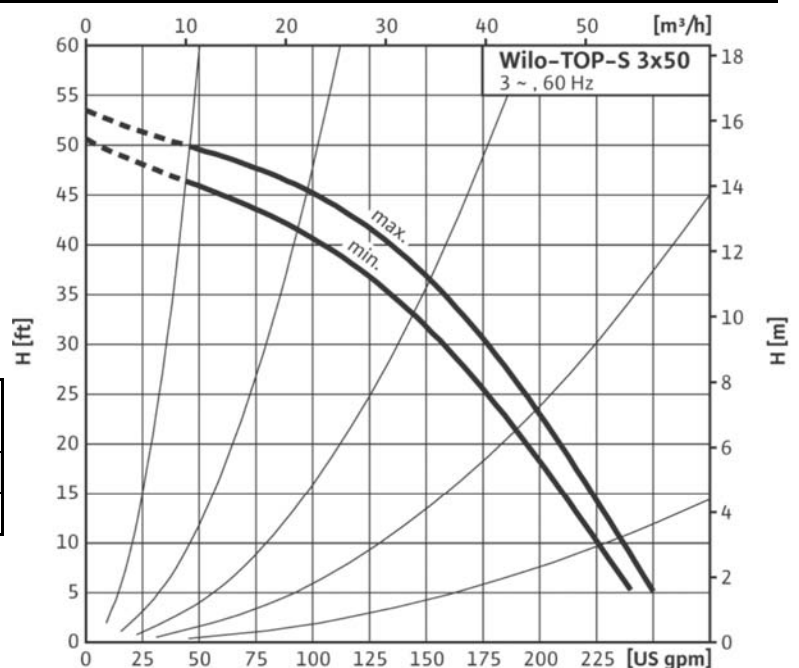



# WILO TOP S Submittal

Top S 3.0 x 70 Three Phase Series



Pumpen Intelligenz.

|               |       |
|---------------|-------|
| Project:      |       |
| Engineer:     |       |
| Contractor:   |       |
| Submitted By: | Date: |
| Approved By:  | Date: |

| Tag # | Model #        | Flow | Head | Volt | Phase | Comments |
|-------|----------------|------|------|------|-------|----------|
|       | TOP S 3.0 X 70 |      |      |      | 3     |          |
|       | TOP S 3.0 X 70 |      |      |      | 3     |          |

| Details  | Max Hp    | Pipe Size | l0  | l1  | l2     | a1      | a2    | b1      | b2    | b4    | b6    | Weight    |
|----------|-----------|-----------|-----|-----|--------|---------|-------|---------|-------|-------|-------|-----------|
| Imperial | 2 Hp      | 3"        | 14  | 7   | 6 1/16 | 13 1/16 | 6 1/4 | 4 11/16 | 4 1/4 | 2 3/4 | 2 3/4 | 106.3 lbs |
| Metric   | 1600 Watt | 80 mm     | 356 | 178 | 154    | 332     | 159   | 119     | 108   | 70    | 70    | 48.2 kg   |

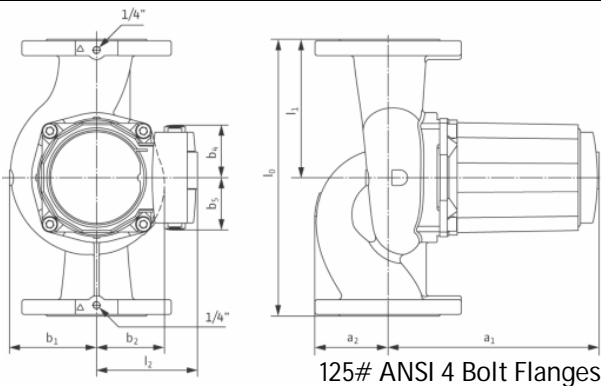

| Speed | RPM  | Max Watts | Amps 208/230 V | 460 V | 575 V |
|-------|------|-----------|----------------|-------|-------|
| Max   | 3470 | 3080      | 10.3           | 5.1   | 4.1   |
| Min   | 3210 | 2450      | 7.7            | 3.9   | 3.1   |

|                   |                    |                    |
|-------------------|--------------------|--------------------|
| 140 deg F (60 C)  | 194 deg F (90 C)   | Min Inlet Pressure |
| 6.3 PSI ( 43 kpa) | 15.4 PSI (105 kpa) |                    |

**Operating Limits**

Max Temp 14 to 248 Deg F (- 10 to 120 Deg C)  
 Max Ambient Temp 104 Deg F (40 Deg C)  
 Max Working Pressure 145 PSI (10 Bar)

**Materials of Construction**

Impeller Polypropylene (50% Glass Filled)  
 Shaft Stainless Steel (X40 Cr13)  
 Bearing Metal Impregnated Carbon  
 Volute Cast Iron (Closed Systems)  
 Cataphoresis Coated

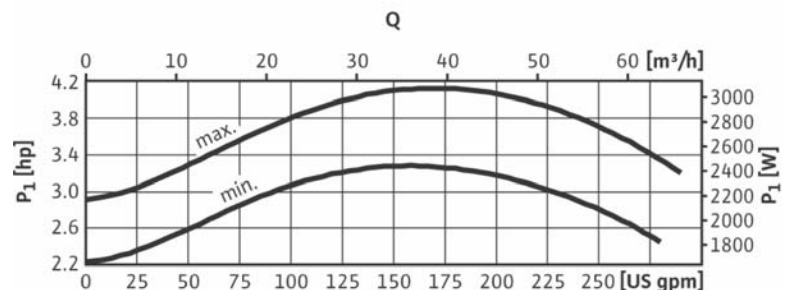
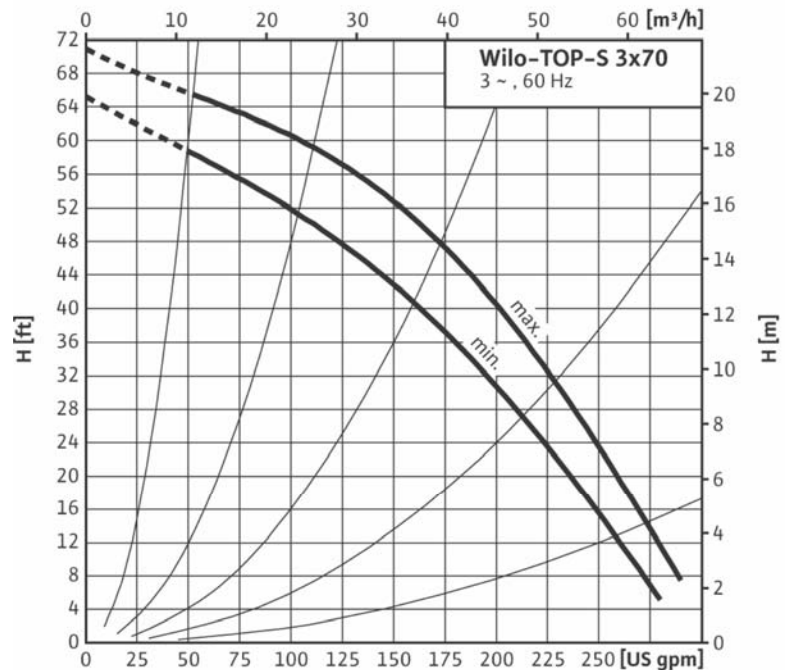

Wilo USA LLC  
 1290 North 25th Avenue  
 Melrose Park, Illinois 60160  
 Phone: 866 945 6872 Fax: 708 338 9455  
 www.wilo-na.com

Wilo Canada Inc  
 Bay 7 - 2915 - 10th Ave N. E.  
 Calgary, Alberta, T2A 5L4  
 Phone: 866 945 6236 Fax: 403 277 9456  
 www.wilo-na.com